

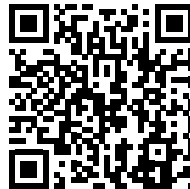

Plasterboard

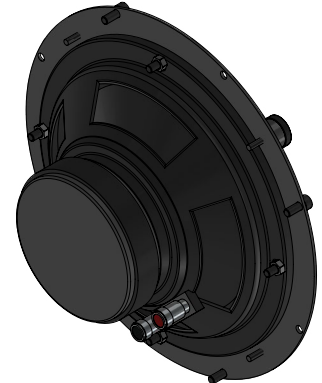

Easy-Fit



**SCAN OR CLICK TO EXTEND
YOUR GARVAN WARRANTY FOR FREE!**

3 years included, with the option to add
2 extra years at no additional cost.

OVERVIEW DESCRIPTION – UNIQUE DESCRIPTION PRODUCT

In-wall and in-ceiling 6,5" (160 mm), 100 W max, coaxial in-wall and in-ceiling speaker with steel mounting frame and speaker body, designed for optimal performance and durability, even in harsh environments. This product supports recessed installation with various integration solutions, including FiloMuro™, suitable for plasterboard and masonry walls, and EasyFit™, ideal for installation in plasterboard walls or other materials such as wood paneling, metal, and porcelain tiles, with thicknesses ranging from 4 to 40 mm. The 6,5" (160 mm) coaxial loudspeaker has a cataphoresis-treated magnetic assembly for corrosion resistance, a treated cellulose cone, a rubber surround, and a 0.5" (14 mm) neodymium tweeter concentrically aligned with the woofer for a balanced, linear sound throughout the frequency range and excellent intelligibility on vocals. Connection to the amplifier is via spring-loaded terminals that can accommodate cables up to AWG14 gauge. The aesthetic cover is securely attached by powerful neodymium magnets. The grille cover can be customized in various materials, including perforated steel that can be painted white tinted or prepainted according to RAL or NCS codes and even treated with galvanic effects. In addition, fabric covers can be used, which are available in a wide selection of textures and colors as shown in Garvan's sample books.

KEY FEATURES

3" (76 mm) Full-Range Driver

Natural and well-balanced audio with clear voice reproduction.

High SPL Output

Reaches up to 111.5 dB SPL @ 1 meter with 80 W max power.

Wide Frequency Response

88 Hz – 20 kHz (-10 dB), ideal for speech and background music.

Sturdy and Compact Build

Steel frame and marine-grade plywood backbox ensure durability.

FiloMuro™ Masonry Integration

Flush-mounted system for masonry walls with a clean, seamless finish.

EasyFit™ Installation

Tool-free front mounting, compatible with panels from 4 to 40 mm.

Versatile Aesthetic Options

Customizable grille: perforated steel, galvanic treatments, prints, or acoustic fabric.

Magnetic Grille Attachment

Strong neodymium magnets for fast and secure placement.

Spring Terminal Connections

Simple wiring with support for cables up to AWG14 (2.08 mm²).

3+1+1 Year Warranty

Long-term warranty included, extendable at no extra cost.

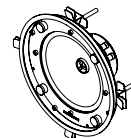
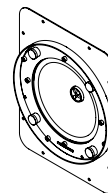

INSTALLATION NAME	Flush-Mount™ Plasterboard	Easy-Fit™
Installation Type	In Wall / In Ceiling Speaker, free air	In Wall / In Ceiling Speaker, free air
Surface Compatibility	Suitable for installation in Plasterboard, wooden panels, modular panel, and similar.	Suitable for installation in Plasterboard, wooden panels, modular panel, and similar.
Installation Requirements	Required support thickness: 12,5- 25mm	Required support thickness: 4-40mm
SINGLE LOUDSPEAKER PERFORMANCE		
AES Power Handling	50 W	50 W
Continuous Power Handling ***	100 W	100 W
Sensitivity 2,83V / 1m ****	89,5 dB	89,5 dB
Sensitivity 1W/1m ****	89,5 dB	89,5 dB
Calculated Maximum SPL @ 1m*	118,5 dB	118,5 dB
TRANSDUCER		
Type	Coaxial	Coaxial
Nominal size	WF 160 mm + TW 14mm	WF 160 mm + TW 14mm
Nominal Impedance	8Ω	8Ω
Loudspeaker EQ	Not required, Garvan Preset EQ, Filter and protection available	Not required, Garvan Preset EQ, Filter and protection available
Recommended High-Pass Filter Protection	60 Hz with 48 dB/ Oct. Hight pass Filter	60 Hz with 48 dB/ Oct. Hight pass Filter
Frequency Response (-3 dB)	80 Hz - 20 kHz **	80 Hz - 20 kHz **
Frequency Range (-10 dB)	60 Hz - 20 kHz	60 Hz - 20 kHz
Nominal Coverage Angle (1 KHz - 4 kHz)	90°	90°
Nominal Coverage (1 KHz – 10 kHz)	90°	90°
PHYSICAL		
Frame Material	zinc-plated metal	zinc-plated metal
Speaker support Material	Lacquered or galvanic metal support	Lacquered or galvanic metal support
Cover	Lacquered or galvanic metal Grille/ Brushed stainless steel Grille / Fabric covered frame.	Lacquered or galvanic metal Grille/ Brushed stainless steel Grille / Fabric covered frame.

ENVIRONMENTAL FEATURES			
Enviropment of Use		Indoor environments	Indoor environments
Operating Temperature Range *****			
environmental protection.			
Connectors		Push connector, mounted on speaker. Accepts 18 AWG (0.8 mm ²) to 15 AWG (2,08 mm ²) size wire.	Push connector, mounted on speaker. Accepts 18 AWG (0.8 mm ²) to 15 AWG (2,08 mm ²) size wire.
Maximum Ceiling Thickness			
Product Dimensions			
Ceiling Cutout			
Net Weight, Frame			
Net Weight, Loudspeaker			
Net Weight, Cover			
LOGISTICAL DATA			
Packaging dimensions			
Shipping Weight			
Quantity of products per package		1 to 2 based on logistics optimization per shipment	1 to 2 based on logistics optimization per shipment
MAINTENANCE			
Cleaning Method		microfiber cloth	microfiber cloth
General precautions		do not use harsh cleaning products	do not use harsh cleaning products
INCLUDED ACCESSORIES			
		Jig set	Jig set
OPTIONAL ACCESSORIES			
Transformer for hight line voltage		TRT052 - 70/100V - 25/37/50W	TRT052 - 70/100V - 25/37/50W
Transformer for hight line voltage		TRT054 - 70/100V - 10/15/20W	TRT054 - 70/100V - 10/15/20W
Cover installation kit		GAR136	GAR136
Sound-absorbing material kit for installation			
Cable size/load	8 ohm	4 ohm	2 ohm
2 sq mm.	20m / 65ft.	10m / 32ft	5m / 16ft
2,5 sq mm.	30m / 100ft.	15m / 50ft	7,5m / 25ft
4 sq mm.	60m / 200ft.	30m / 100ft	15m / 50ft

NOTES:

* Maximum SPL calculated from sensitivity and power handling specifications, using a signal with crest factor 4 (12dB), exclusive of power compression.

** With dedicated preset

*** Power on Continuous Program is defined as 3 dB greater than the Nominal rating.

**** average SPL measured from 200 Hz to 1,5 kHz

***** With dedicated ignition and maintenance process

KR118 / CC2020

FLUSH-MOUNT™ PLASTERBOARD PRODUCT SHEET

FLUSH-MOUNT™ CODES

1 Loudspeaker **KR118**
2 Frame **CC2020**
3 Front cover **81BXX-81AXX**

AES POWER **50 W**
TYPE **COAXIAL**
NOM. SIZE **WF 160 MM + TW 14MM**
NOM. IMP. **8Ω**

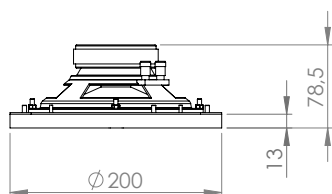
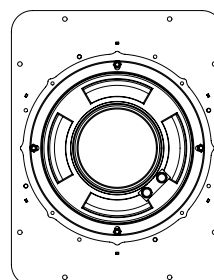
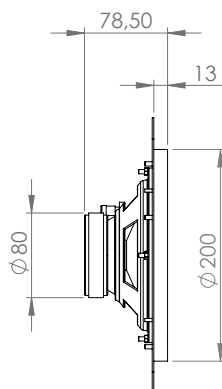
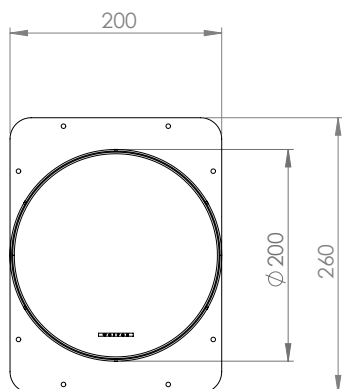
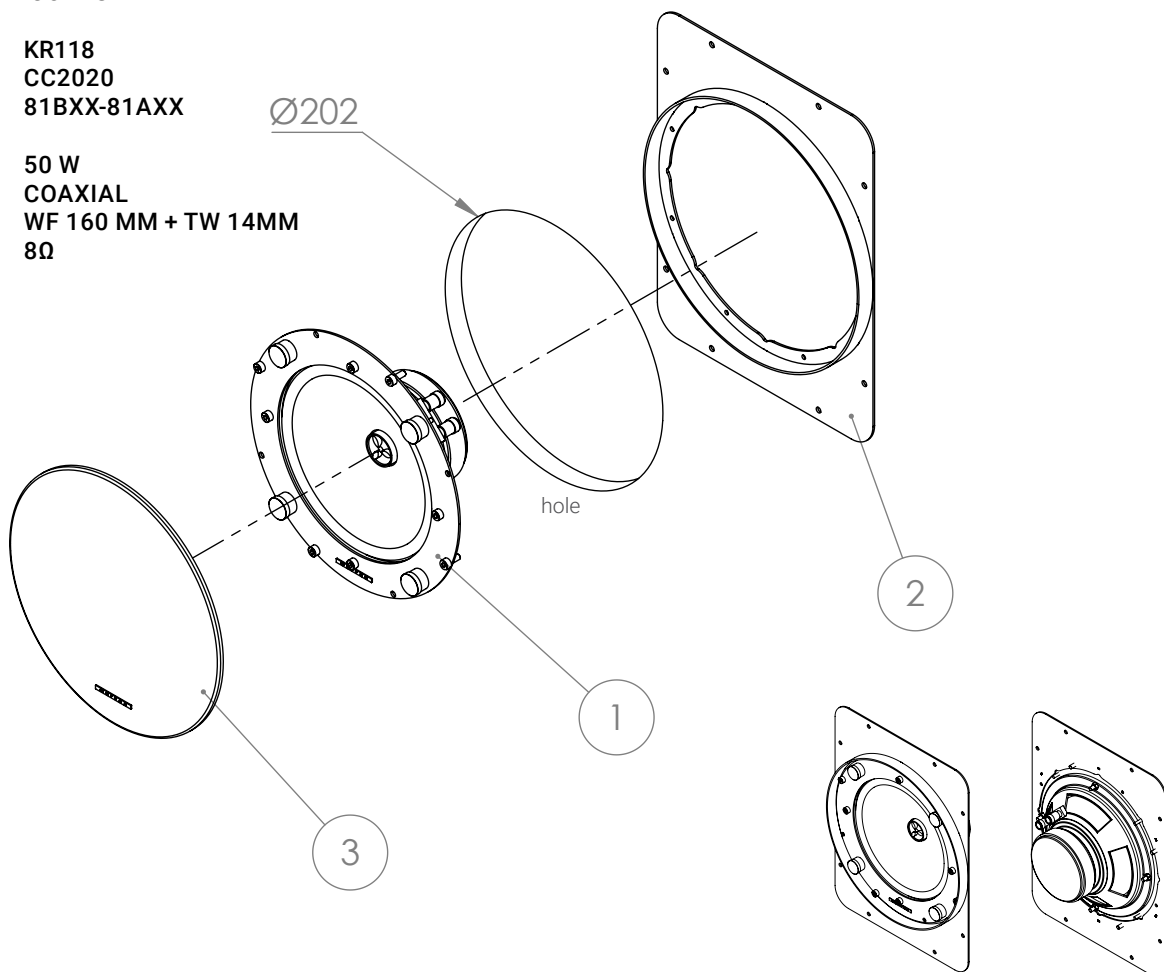

INST. INSTRUCTIONS **KR118 / CC2020 Flush-Mount™** Plasterboard

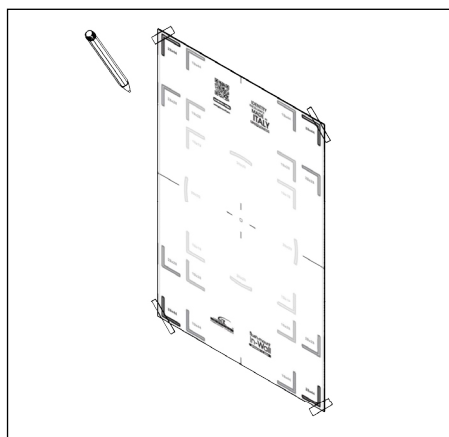

1 Jig set

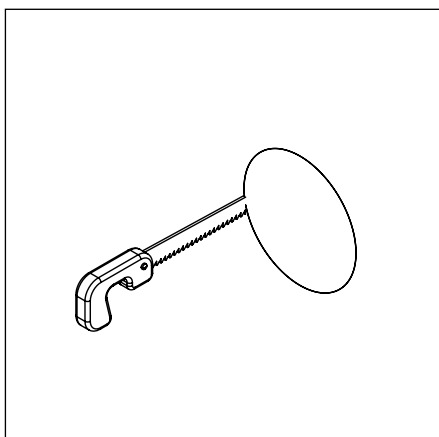

2

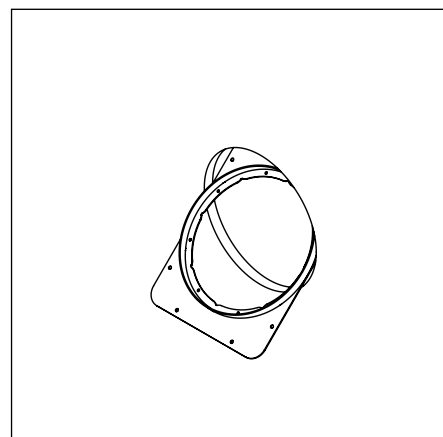

3

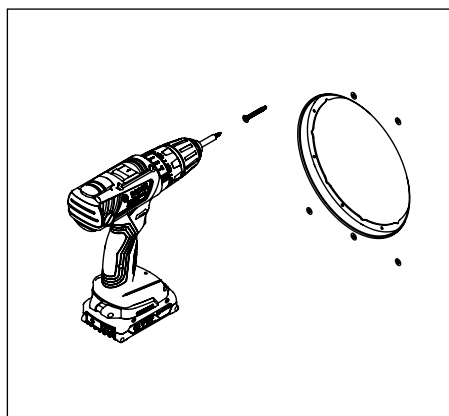

4

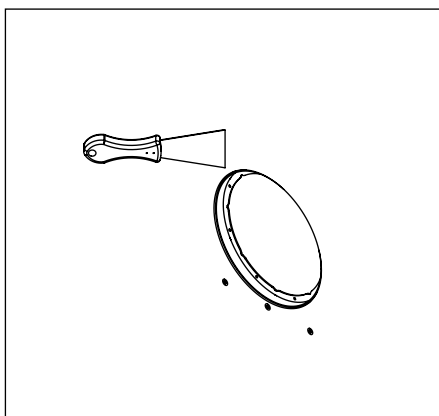

5

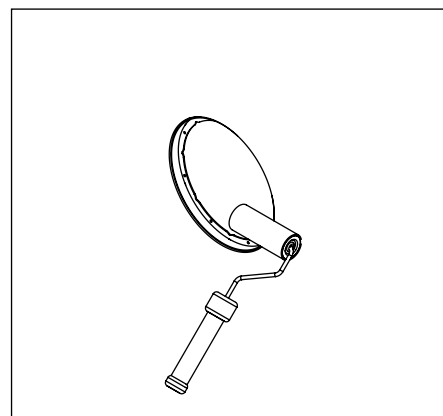

6

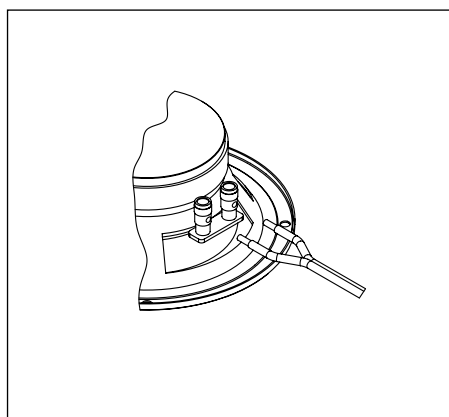

7

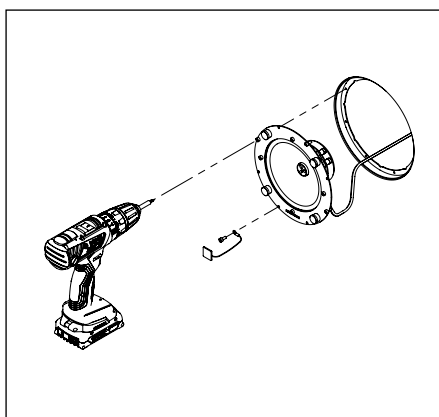

8

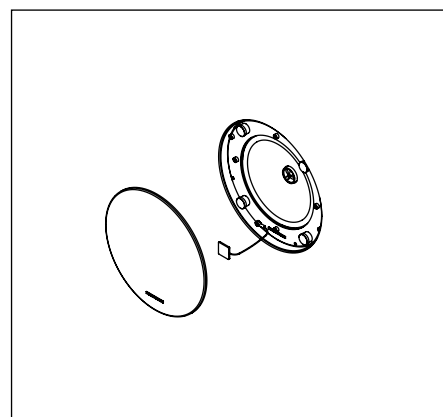

9

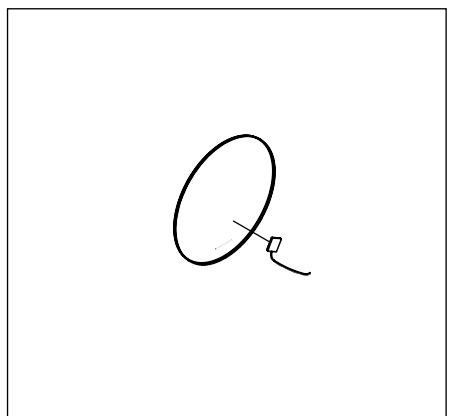

10

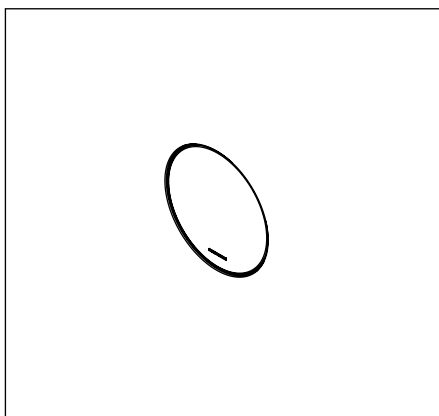

11



EASY-FIT™ CODES

1 Loudspeaker **KR118**
2 Frame **CF2020**
3 Front cover **81BXX-81AXX**

AES POWER **50 W**
TYPE **COAXIAL**
NOM. SIZE **WF 160 MM + TW 14MM**
NOM. IMP. **8Ω**

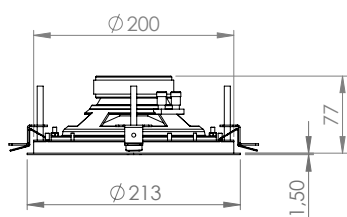
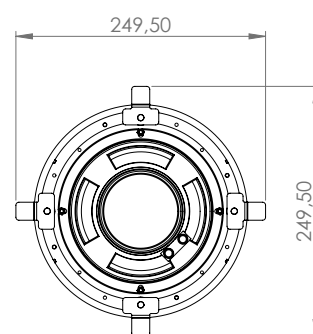
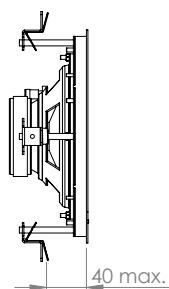
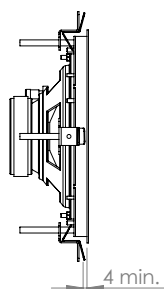
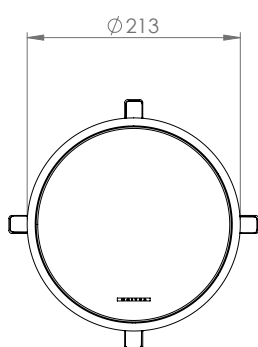
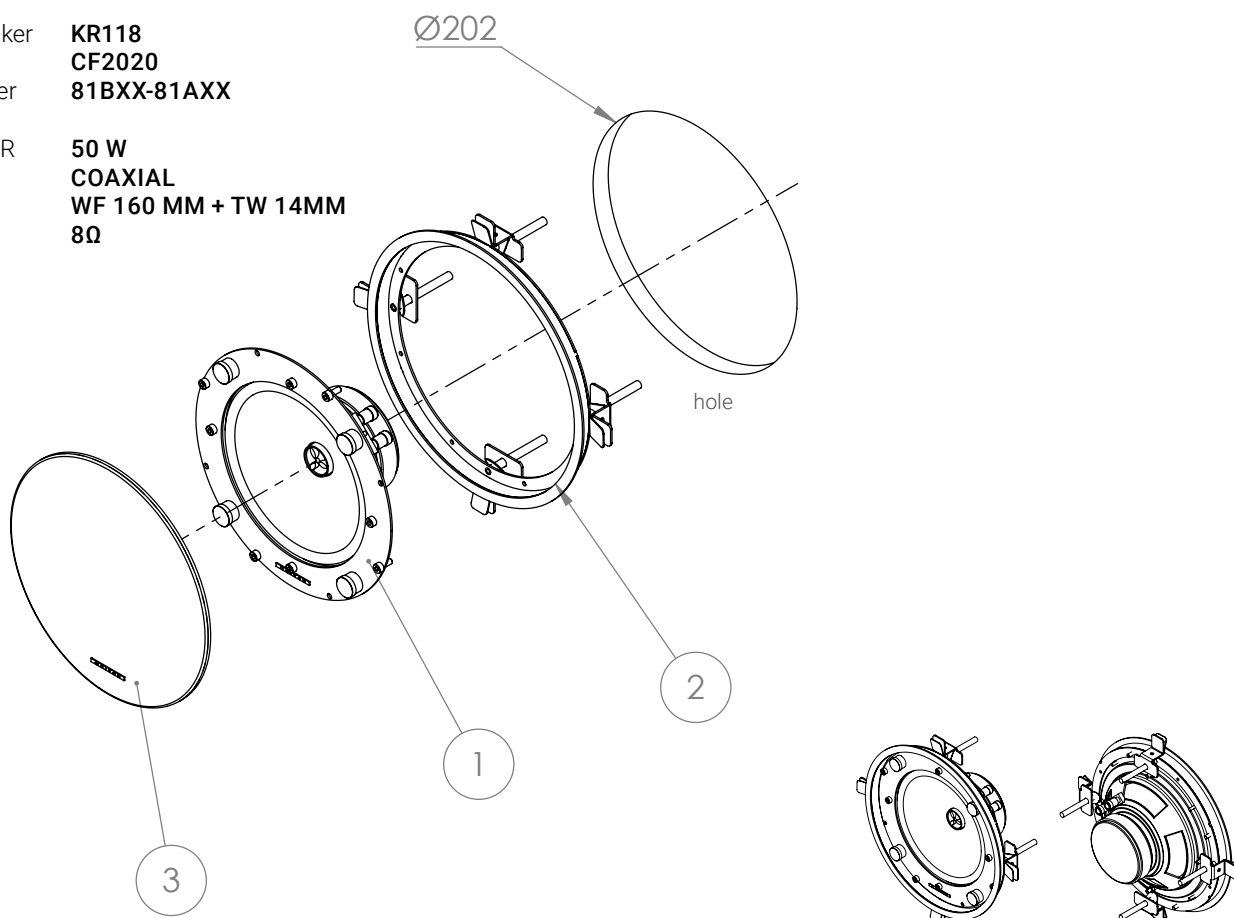

INSTALLATION INSTRUCTIONS **KR118 / CF2020 Easy-Fit™**

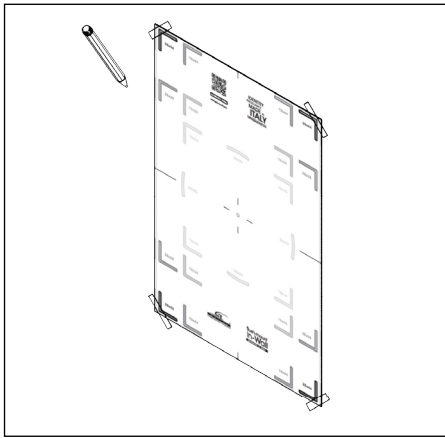

1 Jig set

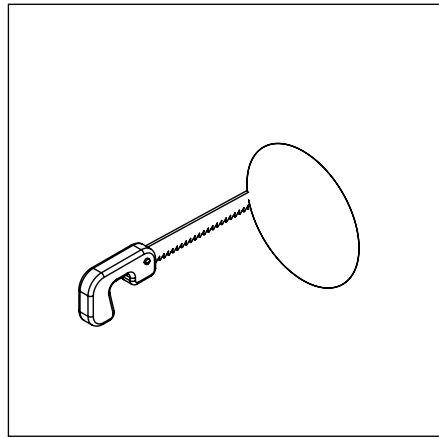

2

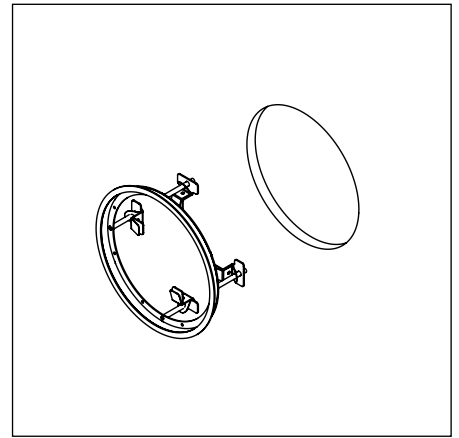

3

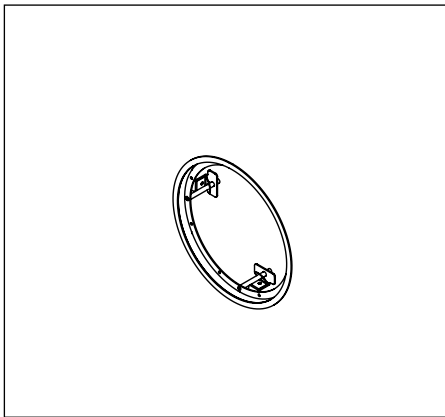

4

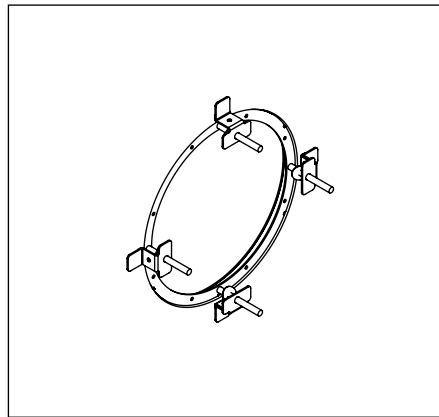

5

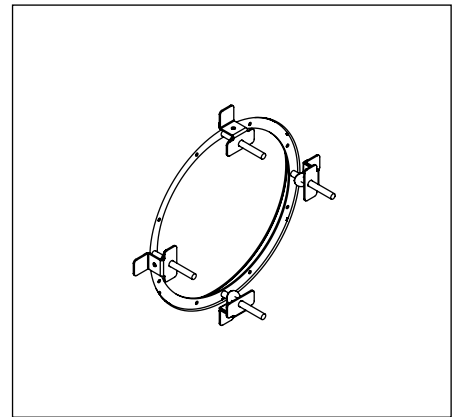

6

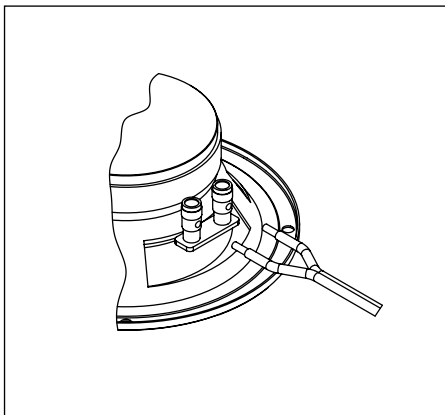

7

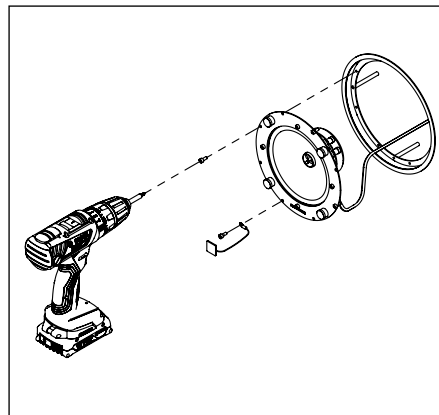

8

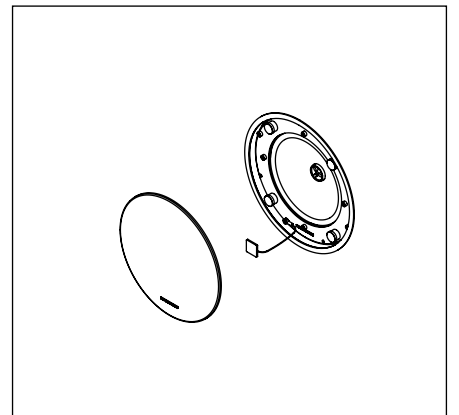

9

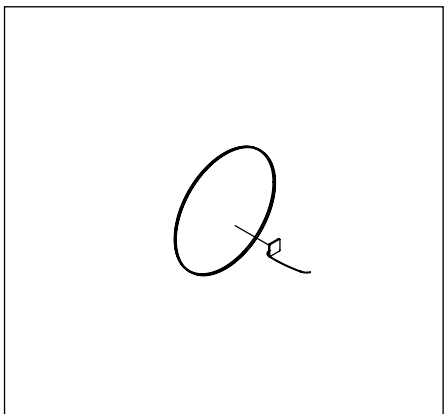

10

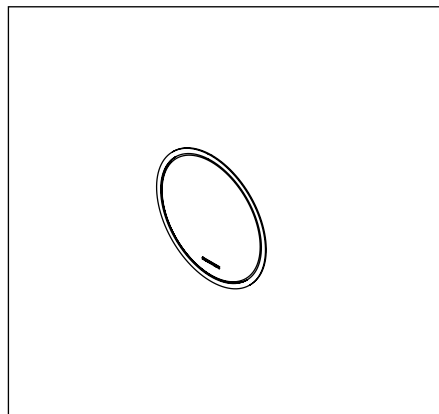

11

