

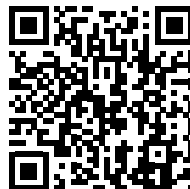

Plasterboard

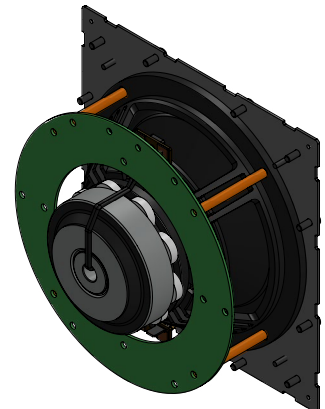

Easy-Fit



**SCAN OR CLICK TO EXTEND
YOUR GARVAN WARRANTY FOR FREE!**

3 years included, with the option to add
2 extra years at no additional cost.

OVERVIEW DESCRIPTION – UNIQUE DESCRIPTION PRODUCT

In-wall and in-ceiling 6.5" (160 mm), 240 W max coaxial in-wall and in-ceiling speaker with steel mounting frame and speaker body, designed for optimal performance and durability, even in harsh environments. This product supports recessed installation with different integration solutions, including FiloMuro™, suitable for plasterboard and masonry walls, and EasyFit™, ideal for installation in plasterboard walls or other materials such as wood paneling, metal, and porcelain tiles, with thicknesses between 4 and 40 mm. The 6.5" (160 mm) coaxial loudspeaker features a neodymium pure magnet assembly with cataphoresis-treated plates for corrosion resistance, a treated cellulose cone, a rubber surround, and a 1" (25 mm) neodymium tweeter coaxially aligned with the woofer for full-bodied, balanced, linear sound throughout the frequency range and excellent intelligibility of vocals. Connection to the amplifier is via spring-loaded terminals that can accommodate cables up to AWG11 gauge. The aesthetic cover is securely fastened by powerful neodymium magnets. The grille cover can be customized in various materials, including perforated steel that can be painted white or prepainted according to RAL or NCS codes and even treated with galvanic effects. In addition, fabric covers can be used, which are available in a wide selection of textures and colors, as shown in Garvan's sample books.

KEY FEATURES

3" (76 mm) Full-Range Speaker
Clear, natural audio with excellent speech intelligibility.

High Power and SPL
Up to 80 W max power and 111.5 dB SPL @ 1 meter.

Wide Frequency Coverage
88 Hz – 20 kHz (-10 dB), perfect for background audio and announcements.

Slim Design with Narrow Grille
Minimal visual impact thanks to compact visible frame.

Durable Construction
Steel body and marine-grade plywood backbox ensure long-lasting performance.

FiloMuro™ Masonry Installation

Flush wall-mounting system for perfect alignment with plastered surfaces.

EasyFit™ Tool-Free Mounting
Compatible with drywall, wood, metal, porcelain panels from 4 to 40 mm.

Customizable Grille Options
Paintable perforated steel, galvanic finishes, graphics, or acoustic fabrics.

Magnetic Grille Locking System
Neodymium magnets for quick and secure grille attachment.

3+1+1 Year Warranty
Includes 3 years standard + 2 years optional free extension.

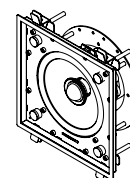
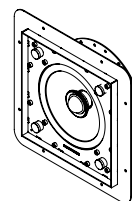

INSTALLATION NAME	Flush-Mount™ Plasterboard	Easy-Fit™
Installation Type	In Wall / In Ceiling Speaker, free air	In Wall / In Ceiling Speaker, free air
Surface Compatibility	Suitable for installation in Plasterboard, wooden panels, modular panel, and similar.	Suitable for installation in Plasterboard, wooden panels, modular panel, and similar.
Installation Requirements	Required support thickness: 12,5- 25mm	Required support thickness: 4-40mm
SINGLE LOUDSPEAKER PERFORMANCE		
AES Power Handling	120 W	120 W
Continuous Power Handling ***	240 W	240 W
Sensitivity 2,83V / 1m ****	88 dB	88 dB
Sensitivity 1W/1m ****	88 dB	88 dB
Calculated Maximum SPL @ 1m*	121 dB	121 dB
TRANSDUCER		
Type	Coaxial	Coaxial
Nominal size	WF 160 mm + TW 25mm	WF 160 mm + TW 25mm
Nominal Impedance	8Ω	8Ω
Loudspeaker EQ	Not required, Garvan Preset EQ, Filter and protection available	Not required, Garvan Preset EQ, Filter and protection available
Recommended High-Pass Filter Protection	50 Hz with 48 dB/ Oct. High pass Filter	50 Hz with 48 dB/ Oct. High pass Filter
Frequency Response (-3 dB)	61 Hz - 20 kHz **	61 Hz - 20 kHz **
Frequency Range (-10 dB)	54 Hz - 20 kHz **	54 Hz - 20 kHz **
Nominal Coverage Angle (1 KHz - 4 kHz)	> 120°	> 120°
Nominal Coverage (1 KHz – 10 kHz)	100°	100°
PHYSICAL		
Frame Material	zinc-plated metal	zinc-plated metal
Speaker support Material	Lacquered or galvanic metal support	Lacquered or galvanic metal support
Cover	Lacquered or galvanic metal Grille/ Brushed stainless steel Grille / Fabric covered frame.	Lacquered or galvanic metal Grille/ Brushed stainless steel Grille / Fabric covered frame.

ENVIRONMENTAL FEATURES			
Environment of Use		Indoor environments	Indoor environments
Operating Temperature Range *****			
environmental protection.			
Connectors		Push connector, mounted on crossover. Accepts 18 AWG (0.8 mm ²) to 14 AWG (2.08 mm ²) size wire.	Push connector, mounted on crossover. Accepts 18 AWG (0.8 mm ²) to 14 AWG (2.08 mm ²) size wire.
Maximum Ceiling Thickness			
Product Dimensions			
Ceiling Cutout			
Net Weight, Frame			
Net Weight, Loudspeaker			
Net Weight, Cover			
LOGISTICAL DATA			
Packaging dimensions			
Shipping Weight			
Quantity of products per package		1 to 2 based on logistics optimization per shipment	1 to 2 based on logistics optimization per shipment
MAINTENANCE			
Cleaning Method		microfiber cloth	microfiber cloth
General precautions		do not use harsh cleaning products	do not use harsh cleaning products
INCLUDED ACCESSORIES			
		Jig set	Jig set
OPTIONAL ACCESSORIES			
Transformer for high line voltage		TRT052 - 70/100V - 25/37/50W	TRT052 - 70/100V - 25/37/50W
Transformer for high line voltage		TRT054 - 70/100V - 10/15/20W	TRT054 - 70/100V - 10/15/20W
Cover installation kit		GAR136	GAR136
Sound-absorbing material kit for installation			
Cable size/load	8 ohm	4 ohm	2 ohm
2 sq mm.	20m / 65ft.	10m / 32ft	5m / 16ft
2,5 sq mm.	30m / 100ft.	15m / 50ft	7,5m / 25ft
4 sq mm.	60m / 200ft.	30m / 100ft	15m / 50ft

NOTES:

* Maximum SPL calculated from sensitivity and power handling specifications, using a signal with crest factor 4 (12dB), exclusive of power compression.

** With dedicated preset

*** Power on Continuous Program is defined as 3 dB greater than the Nominal rating.

**** average SPL measured from 200 Hz to 1,5 kHz

***** With dedicated ignition and maintenance process

KR119 / CC1919

FLUSH-MOUNT™ PLASTERBOARD PRODUCT SHEET

FLUSH-MOUNT™ CODES

1 Loudspeaker **KR119**
2 Frame **CC1919**
3 Front cover **11BXX-11BXM-11AXX-11BMX**

AES POWER **120 W**
TYPE **COAXIAL**
NOM. SIZE **WF 160 MM + TW 25MM**
NOM. IMP. **8Ω**

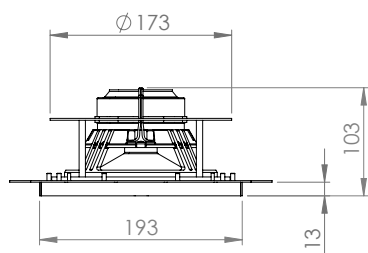
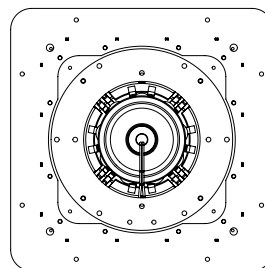
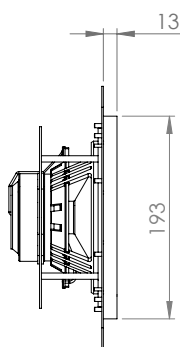
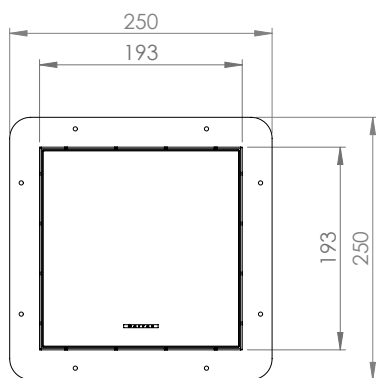
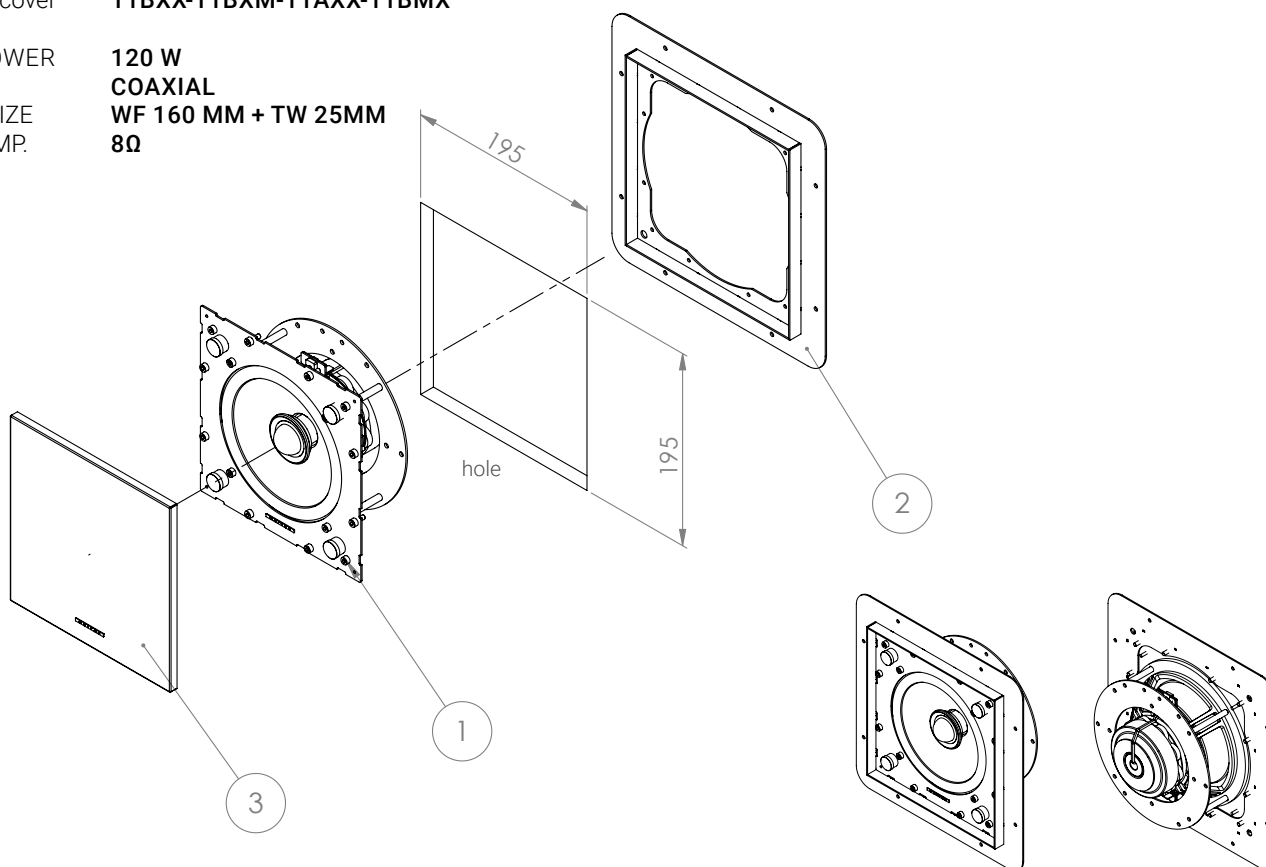

INST. INSTRUCTIONS **KR119 / CC1919 Flush-Mount™ Plasterboard**

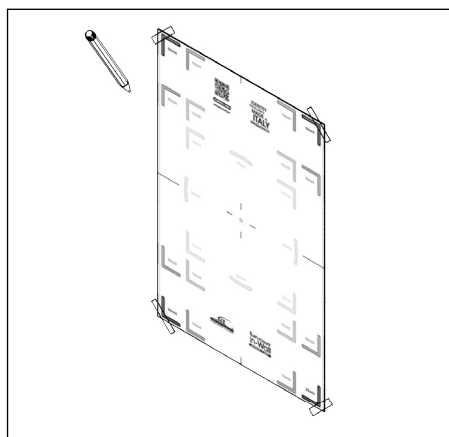

1 Jig set

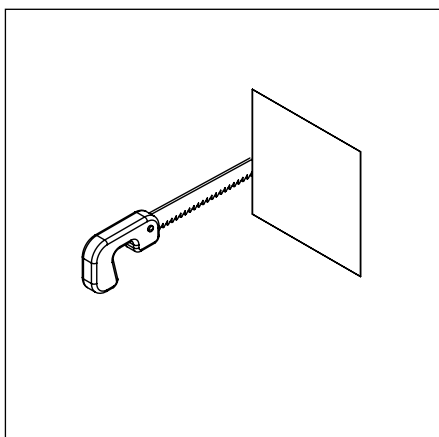

2

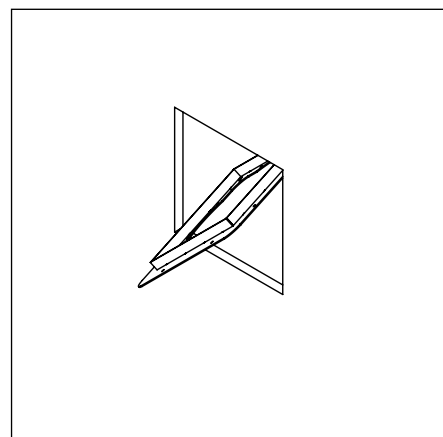

3

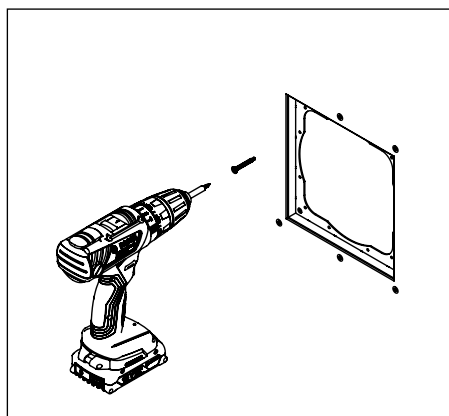

4

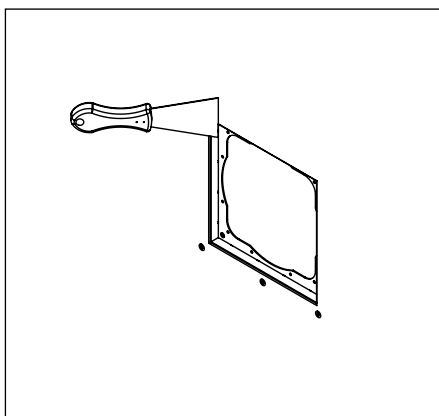

5

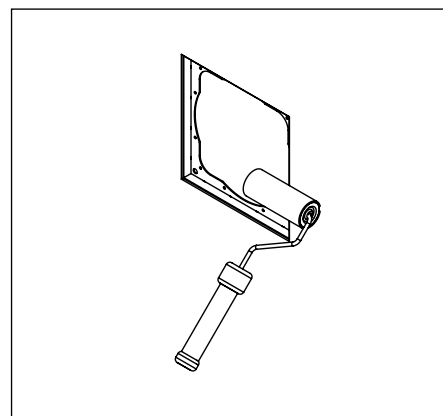

6

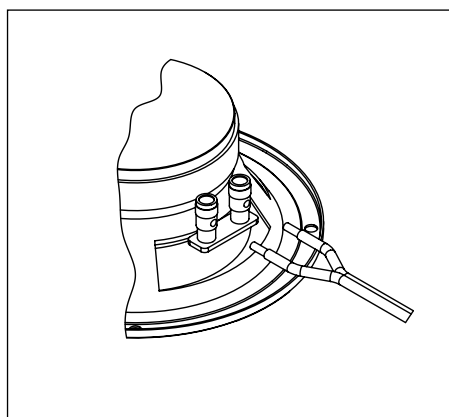

7

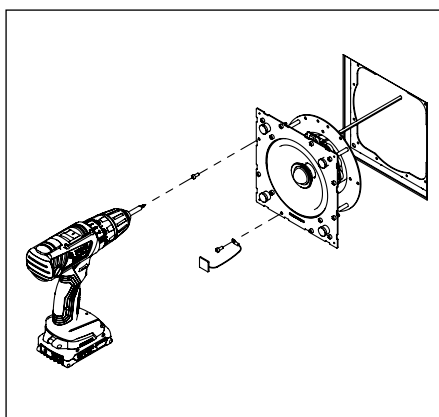

8

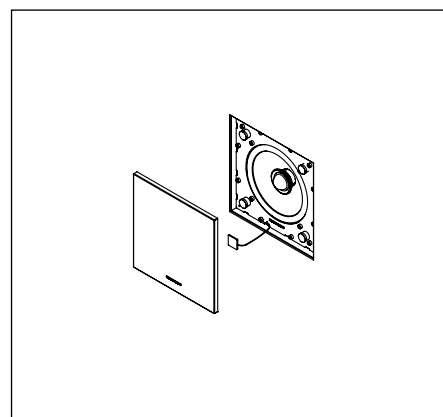

9

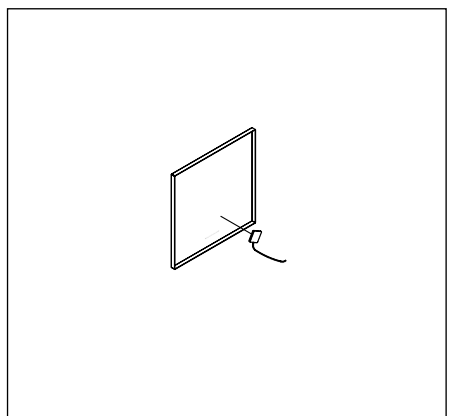

10

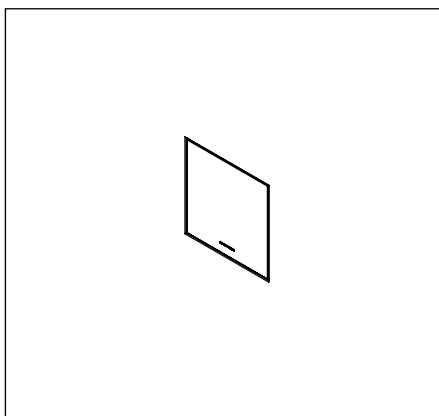

11



EASY-FIT™ CODES

1 Loudspeaker **KR119**
2 Frame **CF191**
3 Front cover **11BXX-11BXM-11AXX-11BMX**

AES POWER **120 W**
TYPE **COAXIAL**
NOM. SIZE **WF 160 MM + TW 25MM**
NOM. IMP. **8Ω**

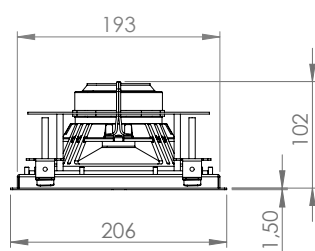
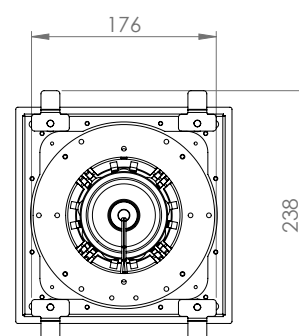
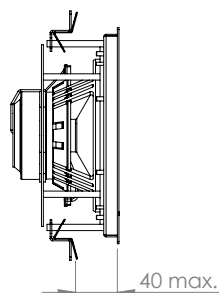
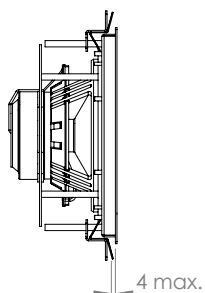
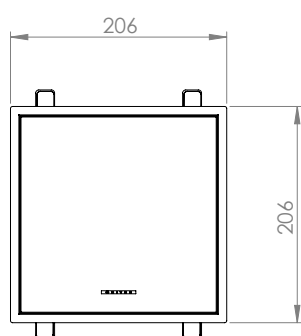
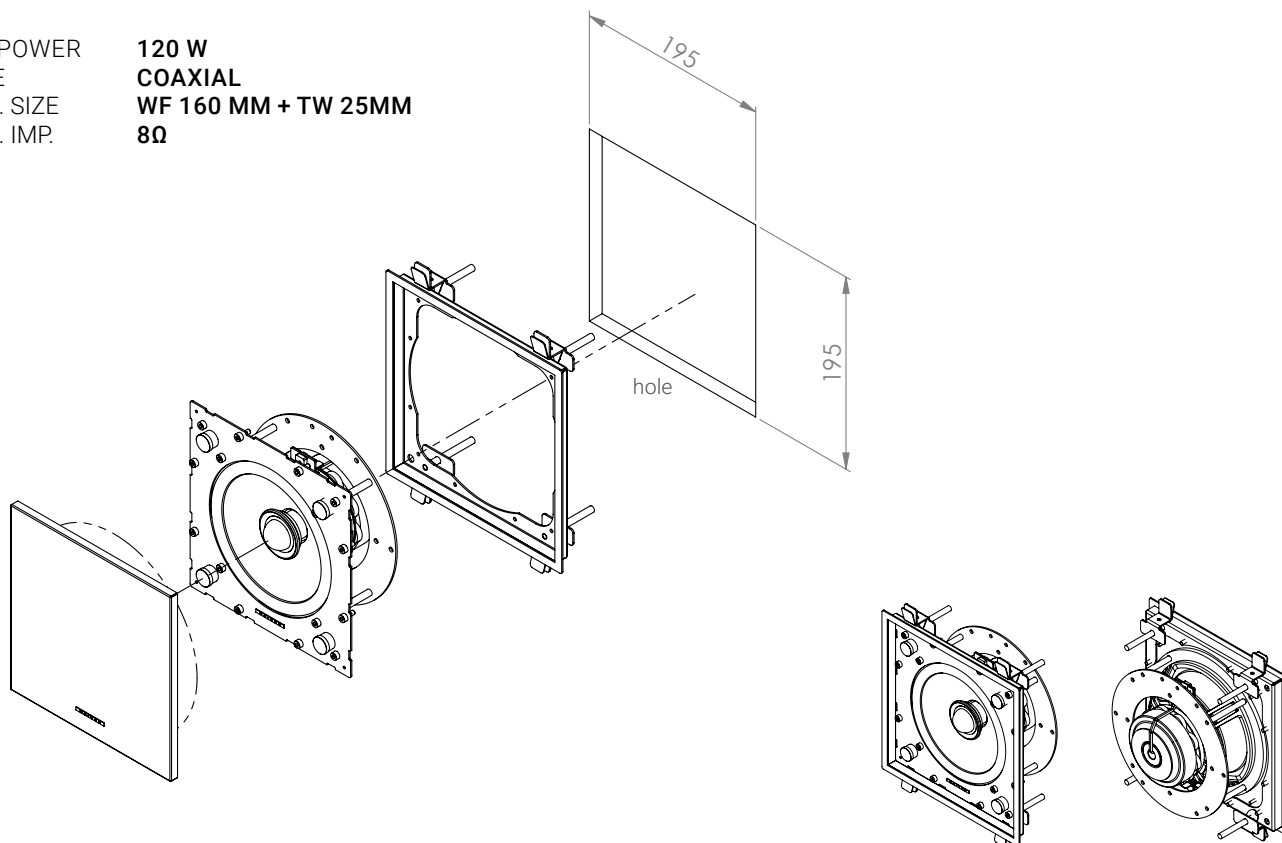

INSTALLATION INSTRUCTIONS **KR119 / CF191 Easy-Fit™**

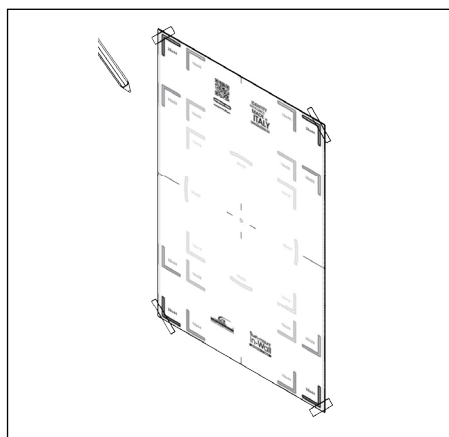

1 Jig set

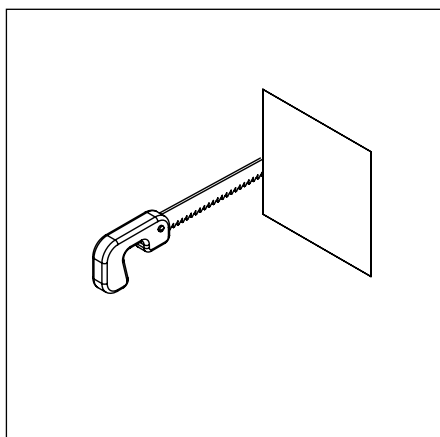

2

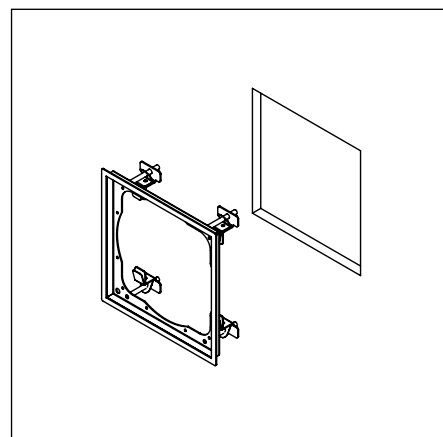

3

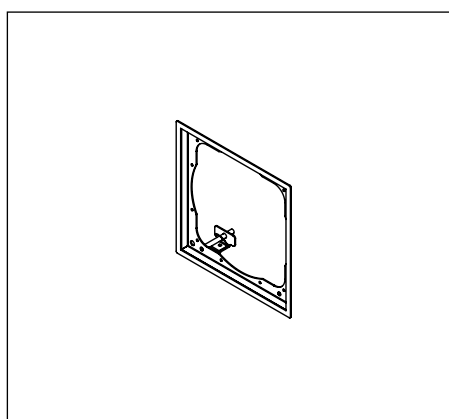

4

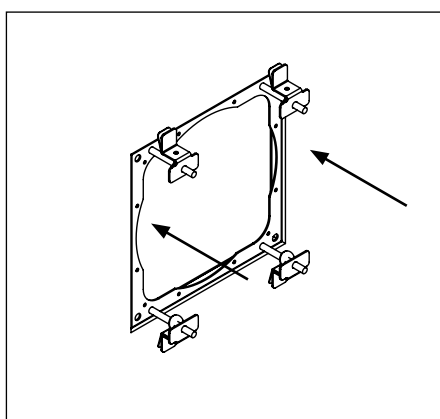

5

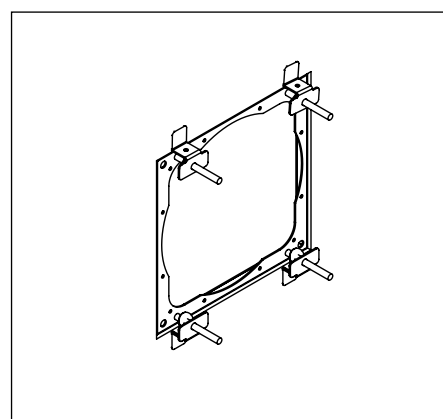

6

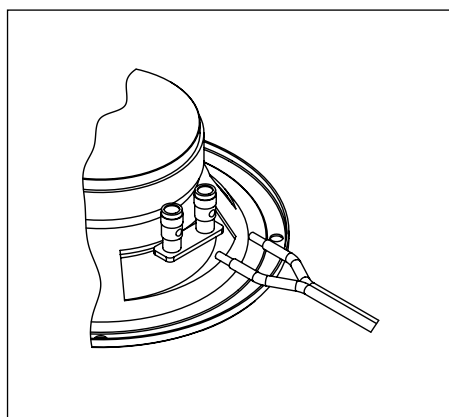

7

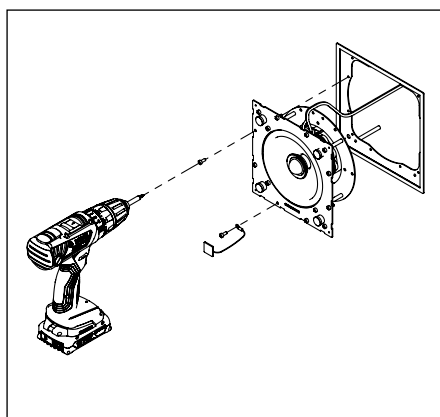

8

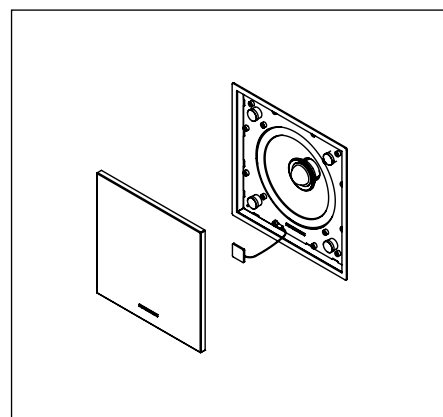

9

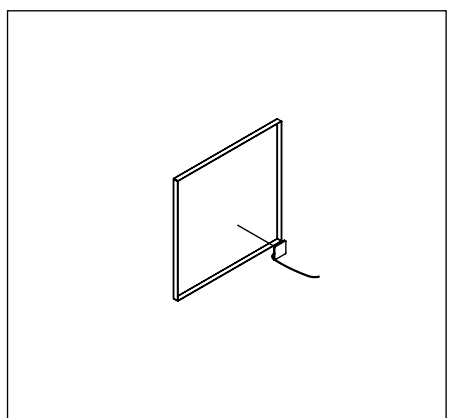

10

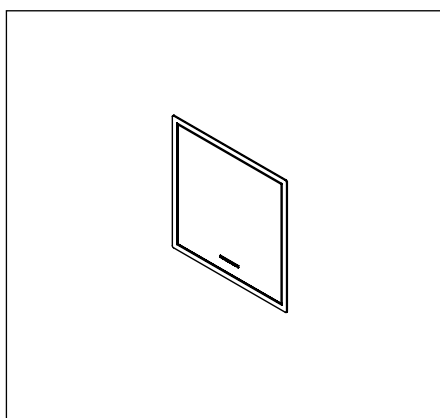

11

