

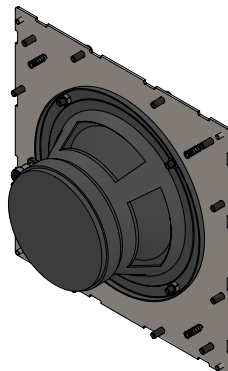

Concrete wall /
Plasterboard

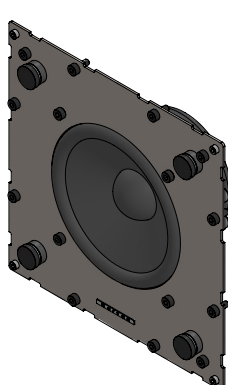

**SCAN OR CLICK TO EXTEND
YOUR GARVAN WARRANTY FOR FREE!**

3 years included, with the option to add
2 extra years at no additional cost.

OVERVIEW DESCRIPTION – UNIQUE DESCRIPTION PRODUCT

5.25" (130 mm) full-range in-wall and in-ceiling speaker, 100 W max, with stainless steel mounting frame and speaker body, and a marine-grade phenolic plywood backbox for masonry installations. Designed for high performance and long-lasting durability, even in harsh environments such as saunas, swimming pools, boats, and seaside resorts.

This product supports recessed installation with multiple integration options, including FiloMuro™, suitable for plasterboard and masonry walls. The 5.25" (130 mm) full-range speaker features a cataphoresis-treated magnet assembly for corrosion resistance, a treated cellulose cone, and a rubber surround, ensuring balanced and linear sound reproduction across the entire frequency range, with excellent vocal intelligibility. Connection to the amplifier is via spring-loaded terminals that accommodate cables up to AWG14. The front cover is securely attached using powerful neodymium magnets.

The grille cover can be customized in various materials, including perforated steel, which can be painted white, pre-painted according to RAL or NCS color codes, or finished with galvanic treatments.

KEY FEATURES

5.25" Full-Range Speaker

Compact design with 130 mm driver for balanced audio performance.

Marine-Grade Construction

Stainless steel frame (AISI 316L) and phenolic marine plywood backbox for maximum durability.

Harsh Environment Ready

Designed for outdoor, marine, sauna, and pool environments. Operating temperature: -25°C to +70°C.

IP66 Rated

Fully protected against dust and powerful water jets for long-term reliability.

Flush-Mount Installation

Supports FiloMuro™ installation for both plasterboard and

concrete walls.

High Power Handling

50W AES, 100W continuous, max SPL up to 117 dB.

Wide Frequency Response

56 Hz – 20 kHz (-10 dB) for concrete walls / 56 Hz – 20 kHz for plasterboard.

Customizable Front Cover

Perforated steel (paintable or galvanic finishes) or fabric cover options, magnetically secured.

Easy Wiring

Push terminals accepting cables from 18 AWG to 15 AWG.

Extended Warranty

3+1+1 years warranty program included

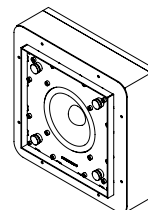
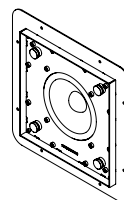

INSTALLATION NAME	Flush-Mount™ Marine Plasterboard	Flush-Mount™ Marine Concrete
Installation Type	In Wall / In Ceiling Speaker, free air	In Wall / In Ceiling Speaker, Closed box
Surface Compatibility	Suitable for installation in Plasterboard, wooden panels, modular panel, and similar.	Suitable for installation in Concrete Wall and similar.
Installation Requirements	Required support thickness: 12,5- 25mm	Minimum required wall thickness: 90mm
SINGLE LOUDSPEAKER PERFORMANCE		
AES Power Handling	50 W	50 W
Continuous Power Handling ***	100 W	100 W
Sensitivity 2,83V / 1m ****	87 dB	88 dB
Sensitivity 1W/1m ****	87 dB	88 dB
Calculated Maximum SPL @ 1m*	116 dB	117 dB
TRANSDUCER		
Type	Full Range	Full Range
Nominal size	1x 130mm	1x 130mm
Nominal Impedance	8Ω	8Ω
Loudspeaker EQ	Not required, Garvan Preset EQ, Filter and protection available	Not required, Garvan Preset EQ, Filter and protection available
Recommended High-Pass Filter Protection	75 Hz with 48 dB/ Oct. High pass Filter	75 Hz with 48 dB/ Oct. High pass Filter
Frequency Response (-3 dB)	97 Hz – 17 kHz	95 Hz - 17 kHz **
Frequency Range (-10 dB)	56 Hz – 20 kHz	75 Hz – 20 kHz **
Nominal Coverage Angle (1 KHz - 4 kHz)	100 °	100 °
Nominal Coverage (1 KHz – 10 kHz)	70 °	70 °
PHYSICAL		
Frame Material	"aisi.316L inox stainless steel + phenolic multilayer wood"	"aisi.316L inox stainless steel + phenolic multilayer wood"
Speaker support Material	Lacquered or galvanic metal support	Lacquered or galvanic metal support
Cover	Lacquered or galvanic metal Grille/ Brushed stainless steel Grille / Fabric covered frame.	Lacquered or galvanic metal Grille/ Brushed stainless steel Grille / Fabric covered frame.

ENVIRONMENTAL FEATURES		
Environment of Use	For use in outdoor, marine, saunas and steam rooms	For use in outdoor, marine, saunas and steam rooms
Operating Temperature Range *****	-25 °C to 70 °C (-13 °F to 158 °F)	-25 °C to 70 °C (-13 °F to 158 °F)
environmental protection.	IP66	IP66
Connectors	Push connector, mounted on speaker. Accepts 18 AWG (0.8 mm ²) to 15 AWG (2,08 mm ²) size wire.	Push connector, mounted on speaker. Accepts 18 AWG (0.8 mm ²) to 15 AWG (2,08 mm ²) size wire.
Maximum Ceiling Thickness		
Product Dimensions		
Ceiling Cutout		
Net Weight, Frame		
Net Weight, Loudspeaker		
Net Weight, Cover		
LOGISTICAL DATA		
Packaging dimensions		
Shipping Weight		
Quantity of products per package	1 to 2 based on logistics optimization per shipment	1 to 2 based on logistics optimization per shipment
MAINTENANCE		
Cleaning Method	microfiber cloth	microfiber cloth
General precautions	do not use harsh cleaning products	do not use harsh cleaning products
INCLUDED ACCESSORIES		
	Jig set	Jig set
OPTIONAL ACCESSORIES		
Transformer for high line voltage	TRT052 - 70/100V - 25/37/50W	TRT052 - 70/100V - 25/37/50W
Transformer for high line voltage	TRT054 - 70/100V - 10/15/20W	TRT054 - 70/100V - 10/15/20W
Cover installation kit	GAR136	GAR136
Sound-absorbing material kit for installation		
CABLE SIZE/LOAD	8 ohm	4 ohm
2 sq mm.	20m / 65ft.	10m / 32ft.
2,5 sq mm.	30m / 100ft.	15m / 50ft.
4 sq mm.	60m / 200ft.	30m / 100ft.
NOTES:		

* Maximum SPL calculated from sensitivity and power handling specifications, using a signal with crest factor 4 (12dB), exclusive of power compression.

** With dedicated preset

*** Power on Continuous Program is defined as 3 dB greater than the Nominal rating.

**** average SPL measured from 200 Hz to 1,5 kHz

***** With dedicated ignition and maintenance process

FLUSH-MOUNT™ MARINE PLASTERBOARD CODES

1 Loudspeaker **KR12M (CC)**
2 Frame **CC1922**
3 Front cover **11BXX**

AES POWER **50 W**
TYPE **FULL RANGE**
NOM. SIZE **1X 130MM**
NOM. IMP. **8Ω**

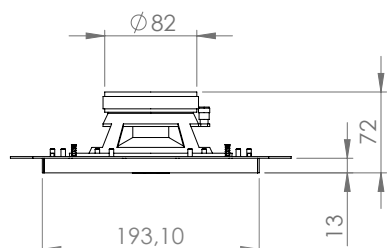
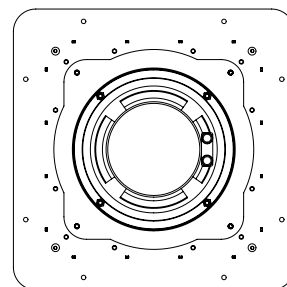
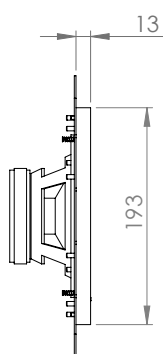
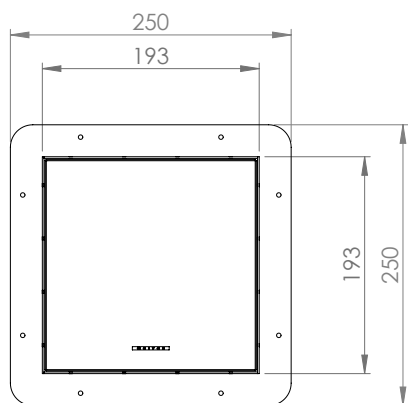
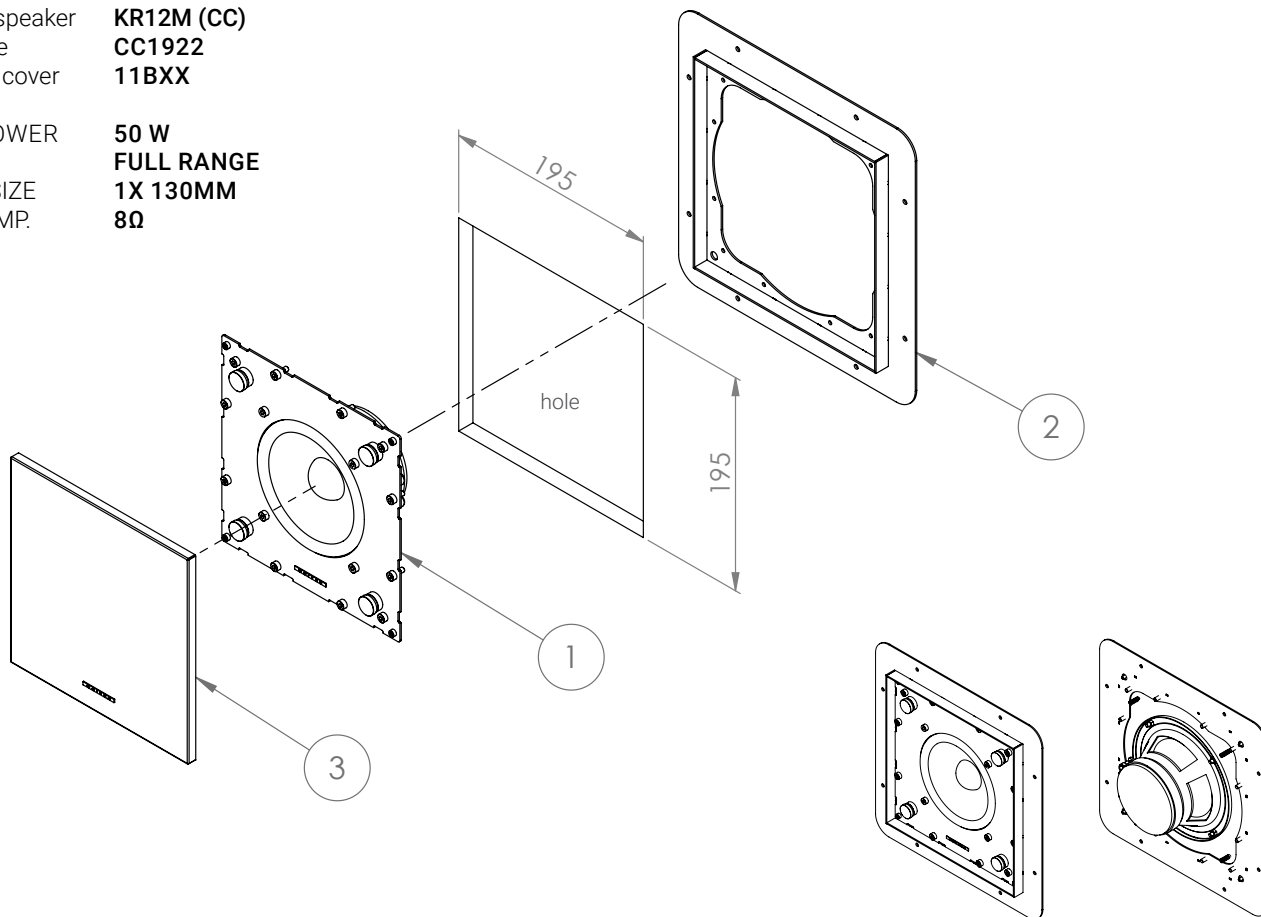

INST. INSTRUCTIONS **KR12M / CC1922 Flush-Mount™ Marine Plasterboard**

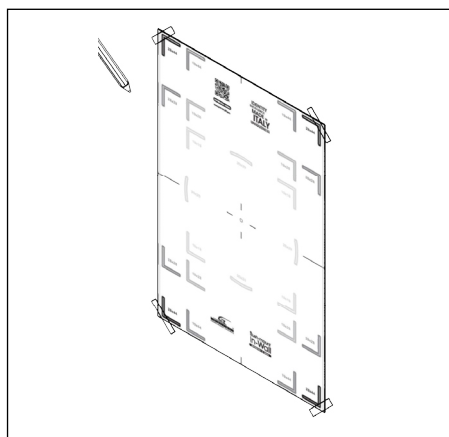

1 Jig set

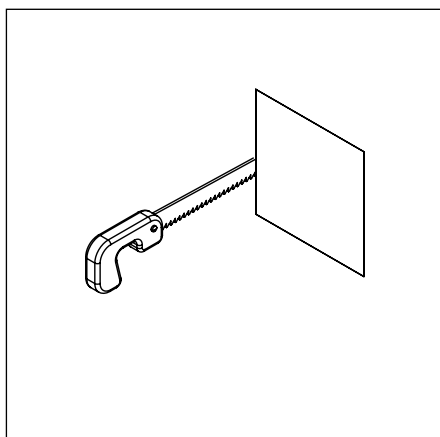

2

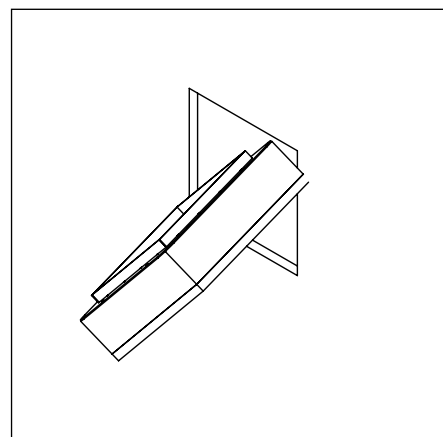

3

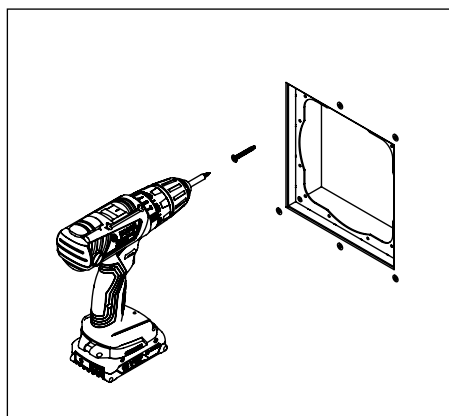

4

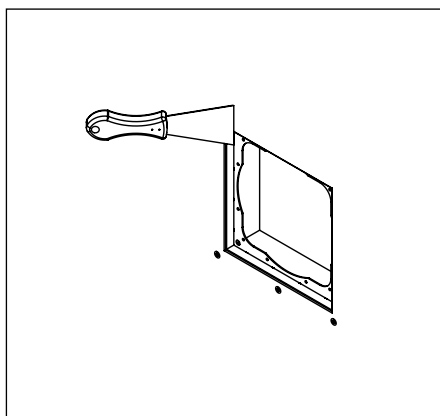

5

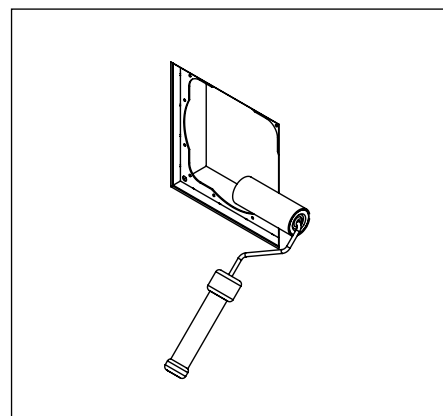

6

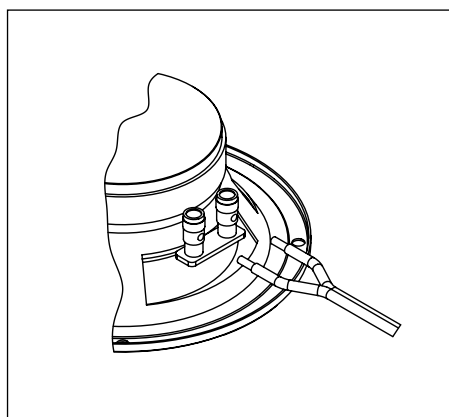

7

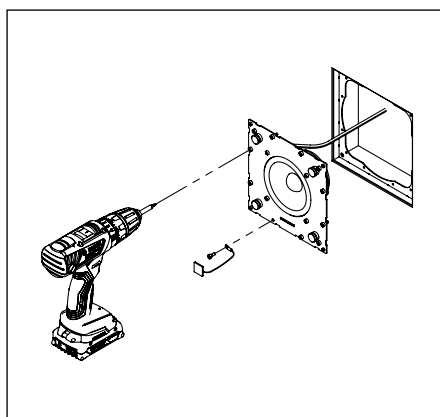

8

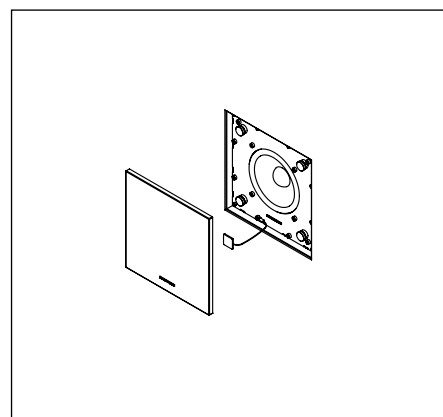

9

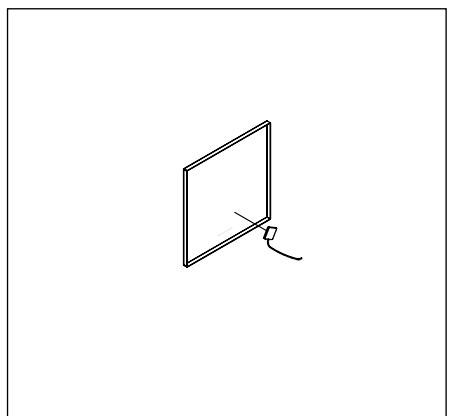

10

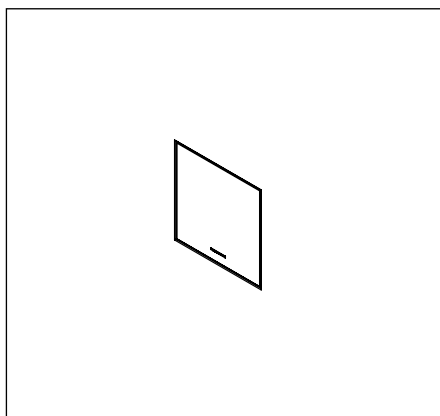

11



FLUSH-MOUNT™ MARINE CONCRETE CODES

1 Loudspeaker **KR12M (CM)**
2 Frame **CC1920**
3 Front cover **11BXX**

AES POWER **50 W**
TYPE **FULL RANGE**
NOM. SIZE **1X 130MM**
NOM. IMP. **8Ω**

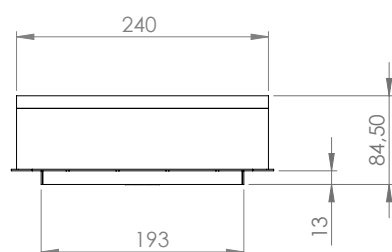
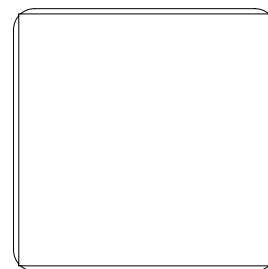
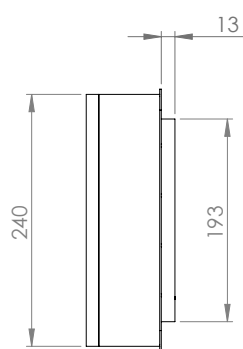
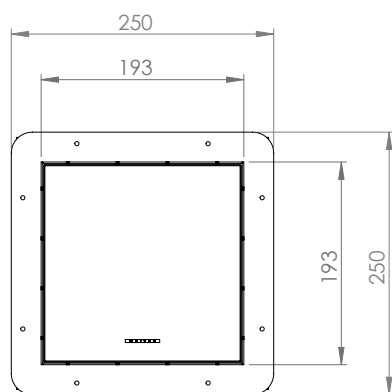
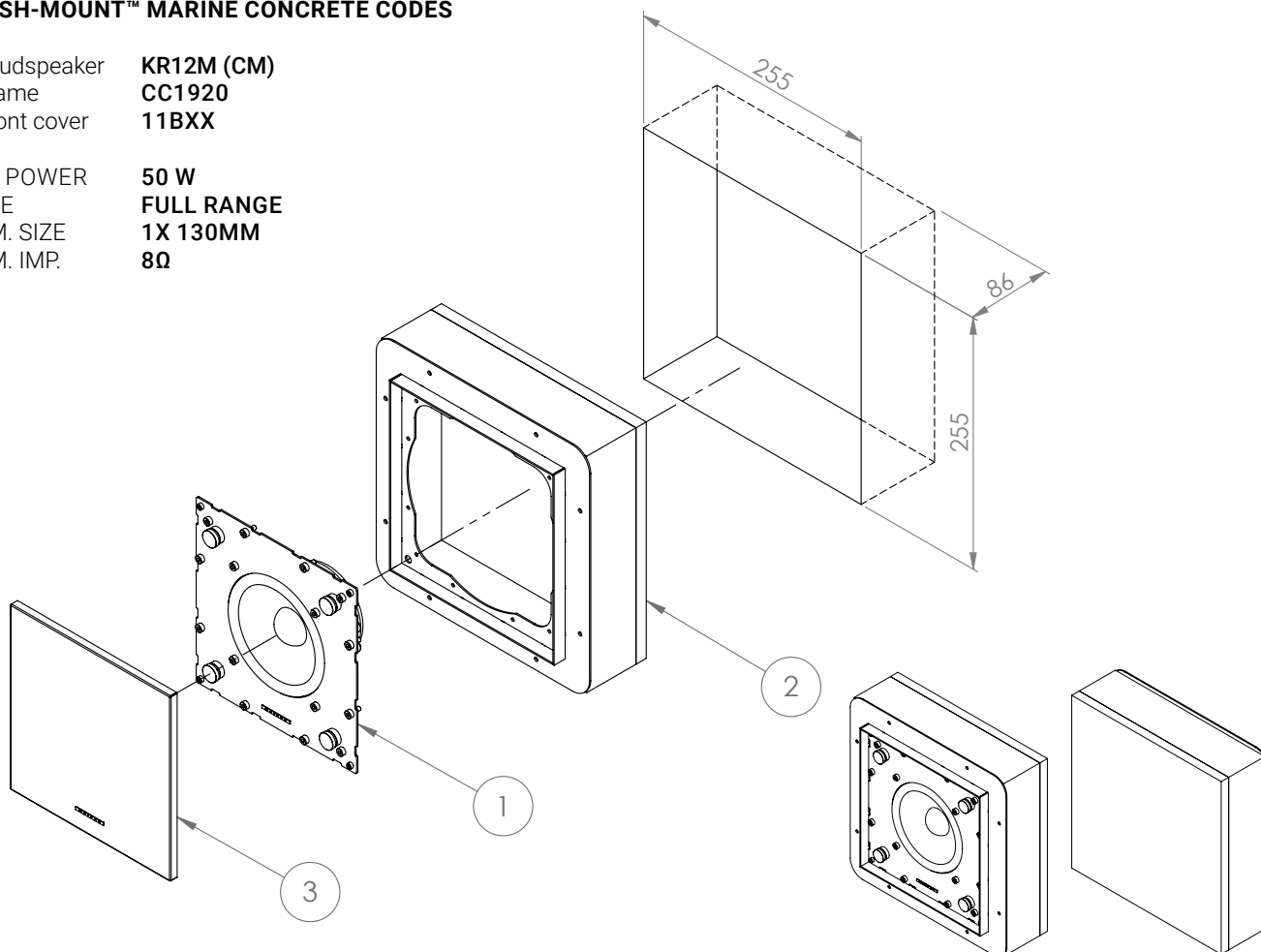

INST. INSTRUCTIONS **KR12M / CC1920 Flush-Mount™** Marine Plasterboard

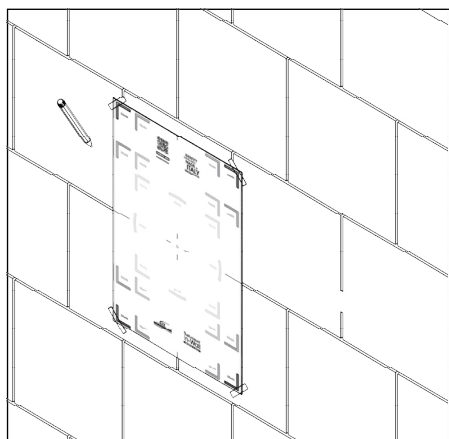

1 Jig set

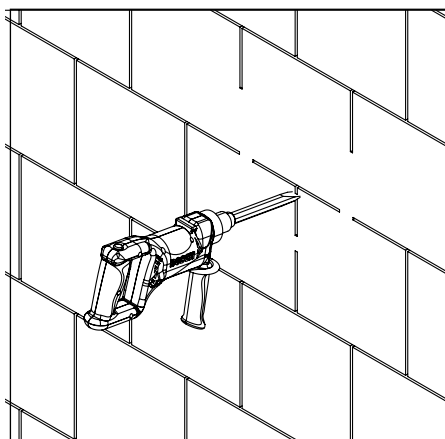

2

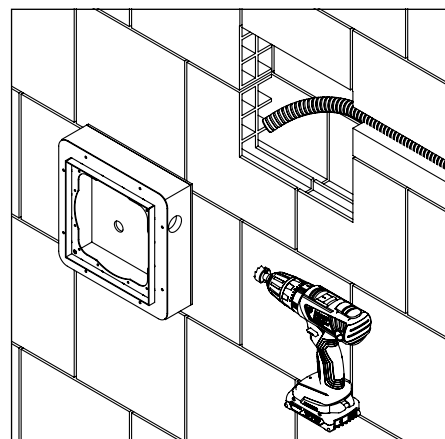

3

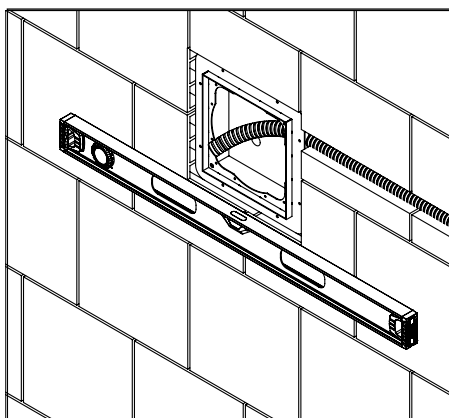

4

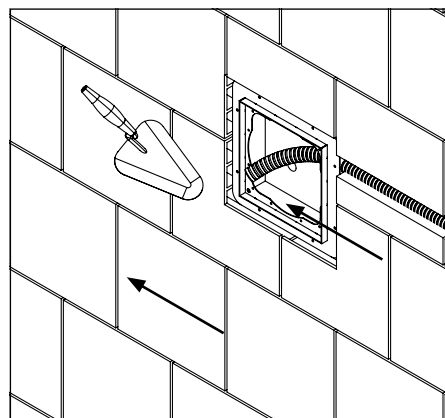

5

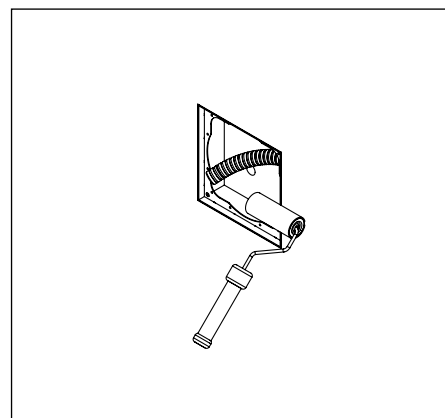

6

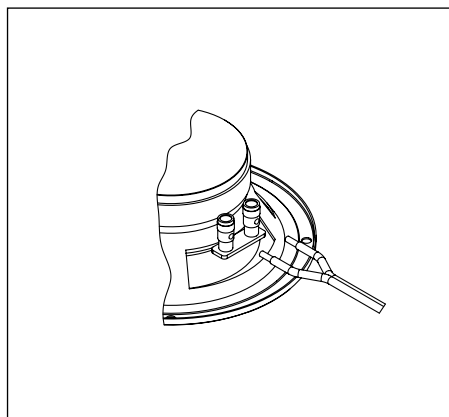

7

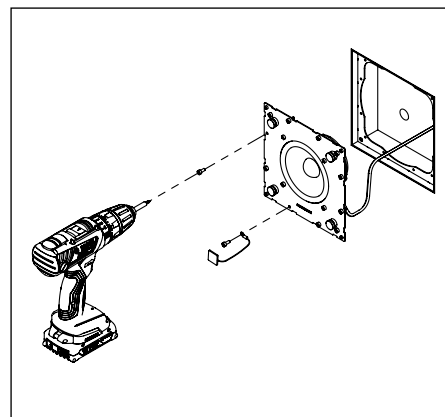

8

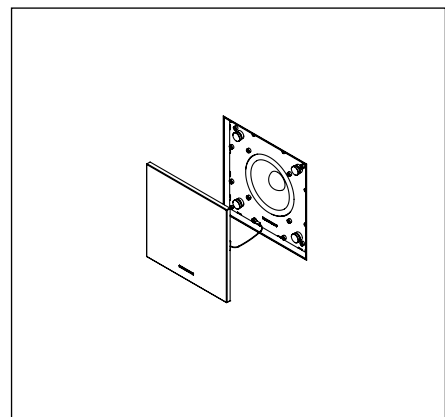

9

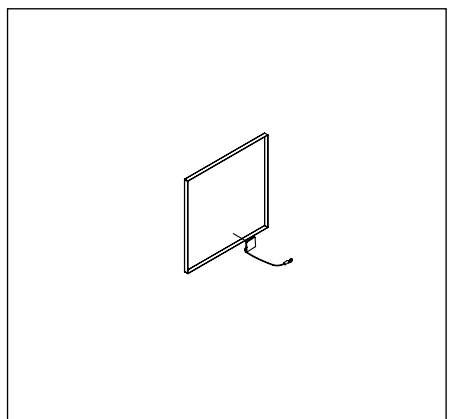

10

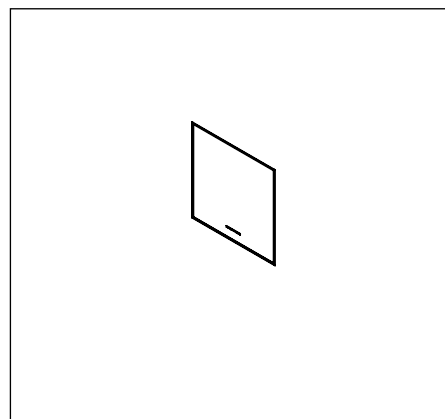

11

