

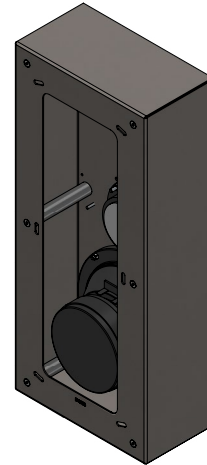

CORO™ COLLECTION



**SCAN OR CLICK TO EXTEND
YOUR GARVAN WARRANTY FOR FREE!**

3 years included, with the option to add
2 extra years at no additional cost.

OVERVIEW DESCRIPTION – UNIQUE DESCRIPTION PRODUCT

The Garvan KW16M is a premium 2-way loudspeaker from the Coro™ Collection, designed for on-wall and on-ceiling installations in both indoor and outdoor environments. Equipped with a 160 mm woofer and a 20 mm tweeter in a closed-box design, it delivers rich bass, detailed mids, and crystal-clear highs with wide and even dispersion. Built from 316L stainless steel with brushed or lacquered finishes, the KW16M ensures maximum durability and seamless architectural integration. With IP56 protection and resistance to extreme temperatures, it is perfectly suited for marine, wellness, and outdoor applications, combining Made in Italy design with robust acoustic performance.

KEY FEATURES

2-way loudspeaker with 160 mm woofer + 20 mm tweeter

Power handling: 150 W AES / 300 W continuous

Sensitivity: 86.5 dB (2.83V/1m and 1W/1m)

Maximum SPL: 120.5 dB @ 1 m

Frequency response: 60 Hz – 20 kHz (–3 dB) with preset EQ

Extended range: 50 Hz – 20 kHz (–10 dB)

Wide coverage: >120° (1–4 kHz) / 120° (1–10 kHz)

Closed-box cabinet: brushed or lacquered 316L stainless steel

Weather & marine resistant: suitable for outdoor, sauna, and steam room applications (IP56)

Operating temperature: –25 °C to +70 °C (–13 °F to 158 °F)

Installation versatility: suitable for concrete, plasterboard, wooden, and modular panels

Connectors: push connectors, accepts 18 AWG to 11 AWG wires

Weight: 5.63 kg – robust yet discreet build

Extended warranty: 3+1+1 years with free registration

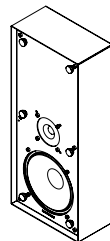

NAME INSTALLATION	On-wall
Type Installation	On-Wall / On-Ceiling Speaker, closed box
Surface Compatibility	Suitable for installation in, concrete wall, Plasterboard, wooden panels, modular panel, and similar.
Installation Requirements:	Support thickness suitable for product weight
SINGLE LOUDSPEAKER PERFORMANCE	
AES Power Handling	150 W
Continuous Power Handling ***	300 W
Sensitivity 2,83V / 1m ****	86,5 dB
Sensitivity 1W/1m ****	86,5 dB
Calculated Maximum SPL @ 1m*	120,5 dB
TRANSDUCER	
Type	2 Way
Nominal size	WF 160 + TW 20mm
Nominal Impedance	8Ω
Loudspeaker EQ	Not required, Garvan Preset EQ, Filter and protection available
Recommended High-Pass Filter Protection	45 Hz with 48 dB/Oct. High pass Filter
Frequency Response (-3 dB)	60 Hz – 20 kHz **
Frequency Range (-10 dB)	50 Hz – 20 kHz **
Nominal Coverage Angle (1 KHz - 4 kHz)	>120 °
Nominal Coverage (1 KHz – 10 kHz)	120 °
PHYSICAL	
Frame Material	brushed or lacquered 316L stainless steel cabinet
Speaker support Material	Brushed aisi.316L stainless steel support
Cover	Laquered or galvanic metal Grille/ Brusced stainlenss steel Grille / Fabric covered frame.
ENVIRONMENTAL FEATURES	
Enviropment of Use	For use in out-door, marine, saunas and steam rooms
Operating Temperature Range *****	-25 °C to 70 °C (-13 °F to 158 °F)
environmental protection.	IP56
Connectors	Push connector, mounted on crossover and on speaker coax. Accepts 18 AWG (0.8 mm ²) to 11 AWG (4,17 mm ²) size wire.
Maximum Ceiling Thickness	
Product Dimensions	
Ceiling Cutout	
Net Weight, Frame	
Net Weight, Loudspeaker	

Net Weight, Cover			
LOGISTICAL DATA			
Packaging dimensions			
Shipping Weight			
Quantity of products per package		1 to 2 based on logistics optimization per shipment	
MAINTENANCE			
Cleaning Method		microfiber cloth	
General precautions		do not use harsh cleaning products	
INCLUDED ACCESSORIES			
OPTIONAL ACCESSORIES			
Transformer for hight line voltage		TRT052 – 70/100V - 25/37/50W	
Transformer for hight line voltage		TRT054 – 70/100V - 10/15/20W	
Cover installation kit		GAR136	
Cable size/load	8 ohm	4 ohm	2 ohm
2 sq mm.	20m / 65ft.	10m / 32ft	5m / 16ft
2,5 sq mm.	30m / 100ft.	15m / 50ft	7,5m / 25ft
4 sq mm.	60m / 200ft.	30m / 100ft	15m / 50ft
NOTES:			

* Maximum SPL calculated from sensitivity and power handling specifications, using a signal with crest factor 4 (12dB), exclusive of power compression.

** With dedicated preset

*** Power on Continuous Program is defined as 3 dB greater than the Nominal rating.

**** average SPL measured from 200 Hz to 1,5 kHz

***** With dedicated ignition and maintenance process

ON-WALL CODES

1 Loudspeaker **KW16M**
2 Frame **CW1111**
3 Front cover **11BXM**

AES POWER **150 W**
TYPE **2 WAY**
NOM. SIZE **WF 160 + TW 20 mm**
NOM. IMP. **8Ω**

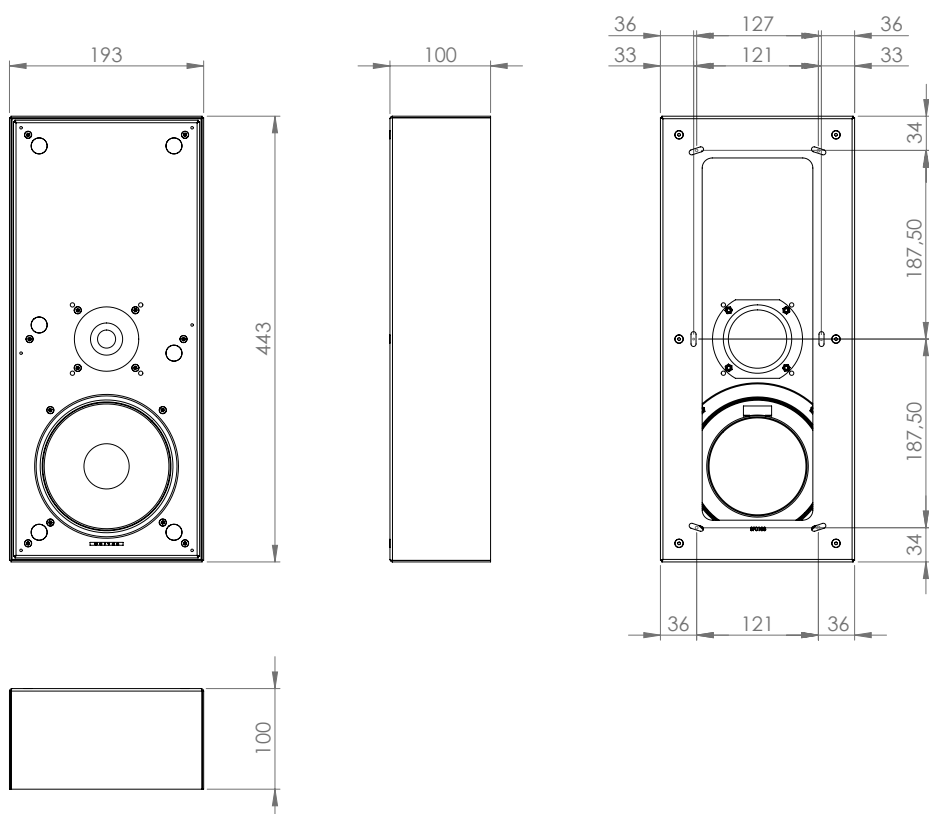
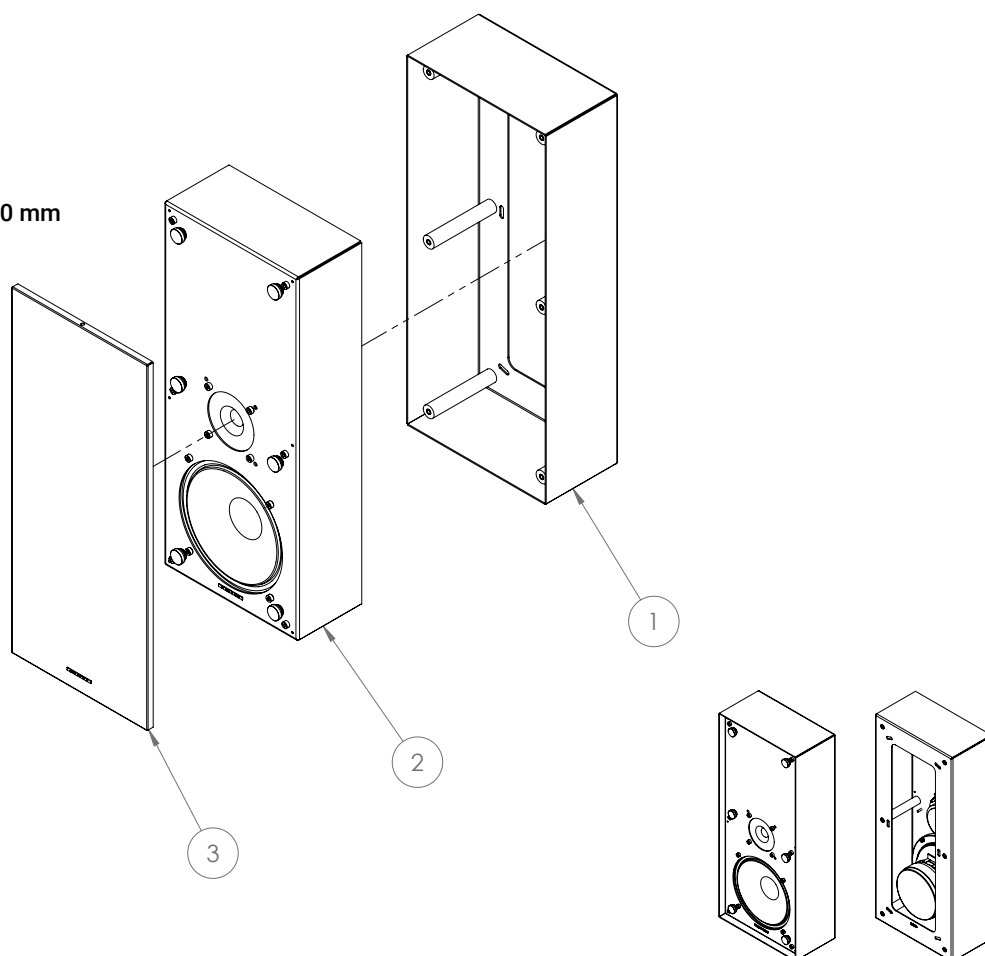

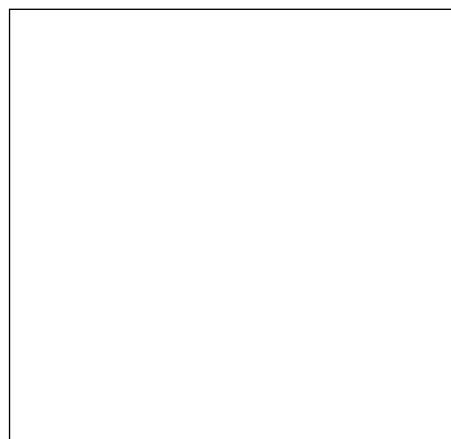

1 Jig set

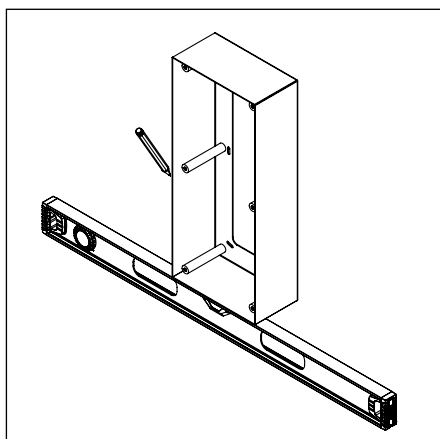

2

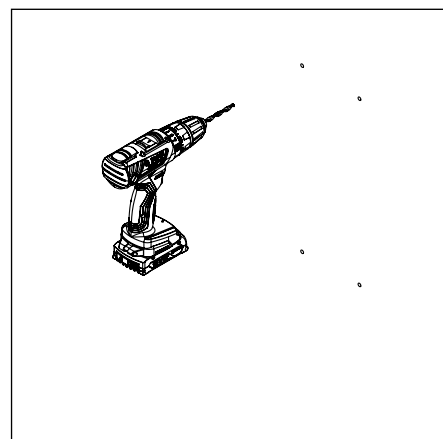

3



4

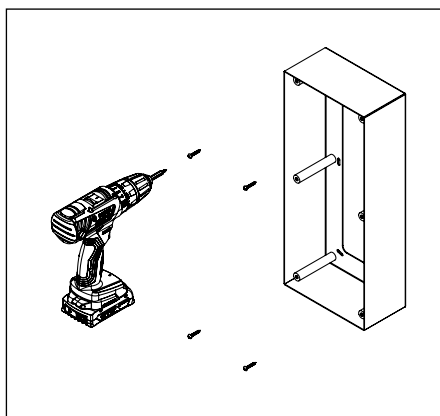

5

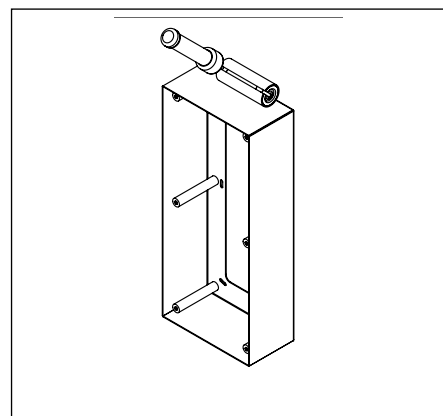

6

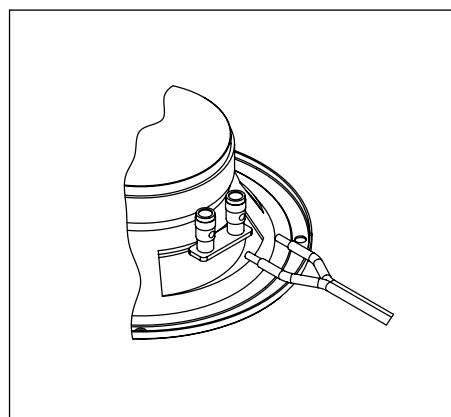

7

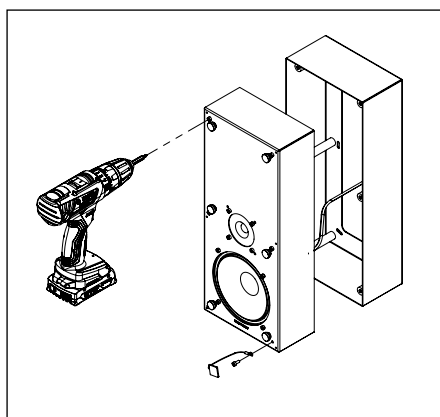

8

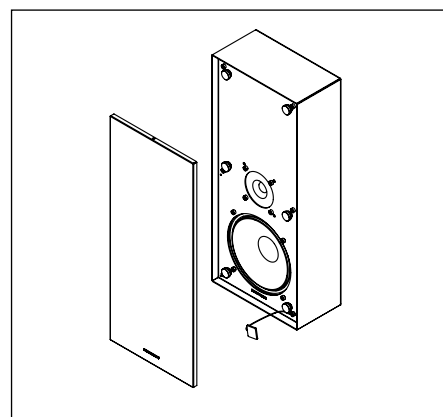

9

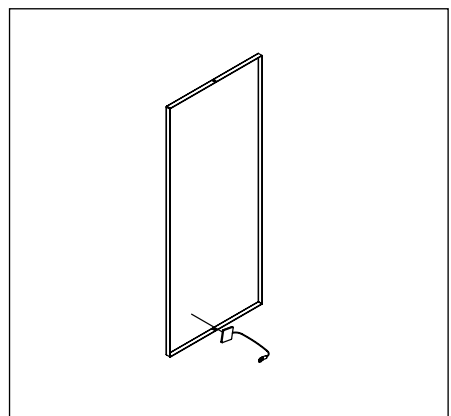

10

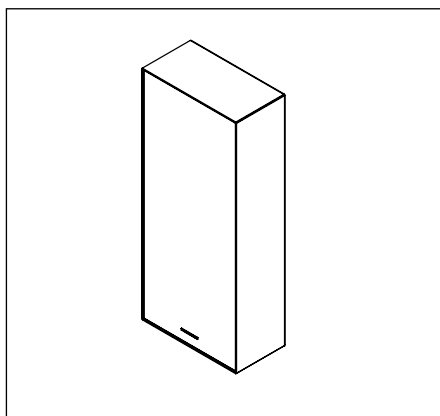

11

