

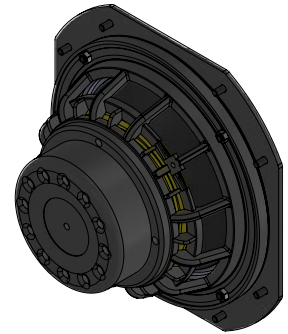

Plasterboard /
Concrete wall

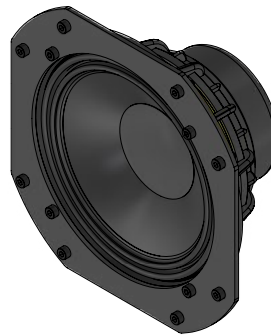

x2

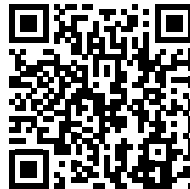

**SCAN OR CLICK TO EXTEND
YOUR GARVAN WARRANTY FOR FREE!**

3 years included, with the option to add
2 extra years at no additional cost.

OVERVIEW DESCRIPTION – UNIQUE DESCRIPTION PRODUCT

2x 6.5" (160 mm) in-wall and in-ceiling subwoofer speaker, 600 W max, with dedicated mounting frame with G-Bass™ system to maximize low-frequency acoustic response, steel speaker frame and masonry and plasterboard installation backbox made of phenolic plywood + steel. This product supports FiloMuro™ wall installation, suitable for plasterboard and masonry walls. The 6.5" (160 mm) woofers speakers features a Neodymium magnet assembly, a treated cellulose cone, and a dual-wave rubber surround that allows very wide cone excursion for greater low-frequency extension. Connection to the amplifier is via spring-loaded terminals that can accommodate cables up to AWG11 gauge. The aesthetic cover is securely fastened by powerful neodymium magnets. The grille cover can be customized in various materials, including perforated steel that can be painted white or pre-painted according to RAL or NCS codes and even treated with galvanic effects. Fabric covers can also be used, available in a wide choice of textures and colors, as shown in Garvan's sample books.

KEY FEATURES

Dual 6.5" Drivers: Equipped with two 160 mm woofers for powerful and extended low-frequency response.

600W Max Power Handling: Delivers up to 600W peak power and 300W AES continuous power.

High Sensitivity: 94 dB (1W/1m) and 97 dB (2.83V/1m) ensure high output even with moderate amplification.

G-Bass™ System: Proprietary mounting frame that enhances low-end performance.

Neodymium Magnet & Treated Cellulose Cone: Ensures fast transient response and warm, controlled bass.

In-Wall/In-Ceiling Flush-Mount: Designed for invisible integration into drywall or masonry with a depth of just 130 mm.

Spring-Loaded Terminals: Accepts cables up to AWG11 (4.17 mm²) for secure and efficient connection.

Customizable Magnetic Grille: Available in painted or galvanic perforated steel and a wide range of fabrics.

Robust Construction: Frame in zinc-coated metal and phenolic multilayer wood for durability.

Optional Accessories: Includes transformer kits for 70/100V lines and sound-absorbing material kits.

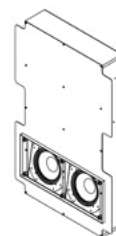

INSTALLATION NAME	
	Flush-Mount™ Concrete wall / Plasterboard
Installation Type	In Wall / In Ceiling Speaker, TL Box
Surface Compatibility	Suitable for installation in Plasterboard, wooden panels, modular panel, and similar.
Installation Requirements	Required support thickness: 12,5-25mm_x0003_ Minimum required wall thickness: 130mm
SINGLE LOUDSPEAKER PERFORMANCE	
AES Power Handling	300W
Continuous Power Handling ***	600W
Sensitivity 2,83V / 1m ****	97dB
Sensitivity 1W/1m ****	94dB
Calculated Maximum SPL @ 1m*	131dB
TRANSDUCER	
Type	Subwoofer
Nominal size	2x WF 160mm
Nominal Impedance	4Ω
Loudspeaker EQ	Not required, Garvan Preset EQ, Filter and protection available
Recommended High-Pass Filter Protection	35 Hz with 48 dB/Oct. High pass Filter
Frequency Response (-3 dB)	35 Hz – 200 Hz **
Frequency Range (-10 dB)	32 Hz – 200 Hz **
Nominal Coverage Angle (1 KHz - 4 kHz)	
Nominal Coverage (1 KHz – 10 kHz)	
PHYSICAL	
Frame Material	"zinc-plated metal + phenolic multilayer wood"
Speaker support Material	Lacquered or galvanic metal support
Cover	Lacquered or galvanic metal Grille/ Brushed stainless steel Grille / Fabric covered frame.
ENVIRONMENTAL FEATURES	
Environment of Use	Indoor environments
Operating Temperature Range *****	
environmental protection.	

Connectors				Push connector, mounted on crossover and on speaker coax. Accepts 18 AWG (0.8 mm2) to 11 AWG (4,17 mm2) size wire.
Maximum Ceiling Thickness				
Product Dimensions				
Ceiling Cutout				
Net Weight, Frame				
Net Weight, Loudspeaker				
Net Weight, Cover				
LOGISTICAL DATA				
Packaging dimensions				
Shipping Weight				
Quantity of products per package				1 to 2 based on logistics optimization per shipment
MAINTENANCE				
Cleaning Method				microfiber cloth
General precautions				do not use harsh cleaning products
INCLUDED ACCESSORIES				
				Jig set
OPTIONAL ACCESSORIES				
Transformer for hight line voltage				TRT052 - 70/100V - 25/37/50W
Transformer for hight line voltage				TRT054 - 70/100V - 10/15/20W
Cover installation kit				GAR136
Sound-absorbing material kit for installation				
Cable size/load	8 ohm	4 ohm	2 ohm	
2 sq mm.	20m / 65ft.	10m / 32ft	5m / 16ft	
2,5 sq mm.	30m / 100ft.	15m / 50ft	7,5m / 25ft	
4 sq mm.	60m / 200ft.	30m / 100ft	15m / 50ft	

NOTES:

* Maximum SPL calculated from sensitivity and power handling specifications, using a signal with crest factor 4 (12dB), exclusive of power compression.

** With dedicated preset

*** Power on Continuous Program is defined as 3 dB greater than the Nominal rating.

**** average SPL measured from 200 Hz to 1,5 kHz

***** With dedicated ignition and maintenance process

FLUSH-MOUNT™ CODES

1 Loudspeaker **WR216**
2 Frame **CR1942**
3 Front cover **11BXXE**

AES POWER **300 W**
TYPE **SUBWOOFER**
NOM. SIZE **2X WF 160MM**
NOM. IMP. **4Ω**

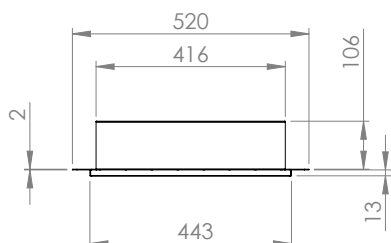
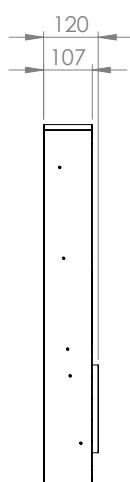
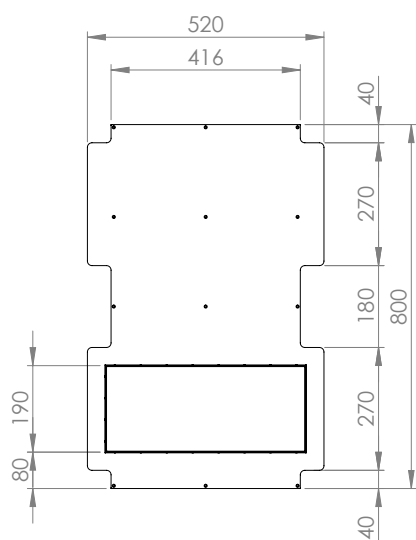
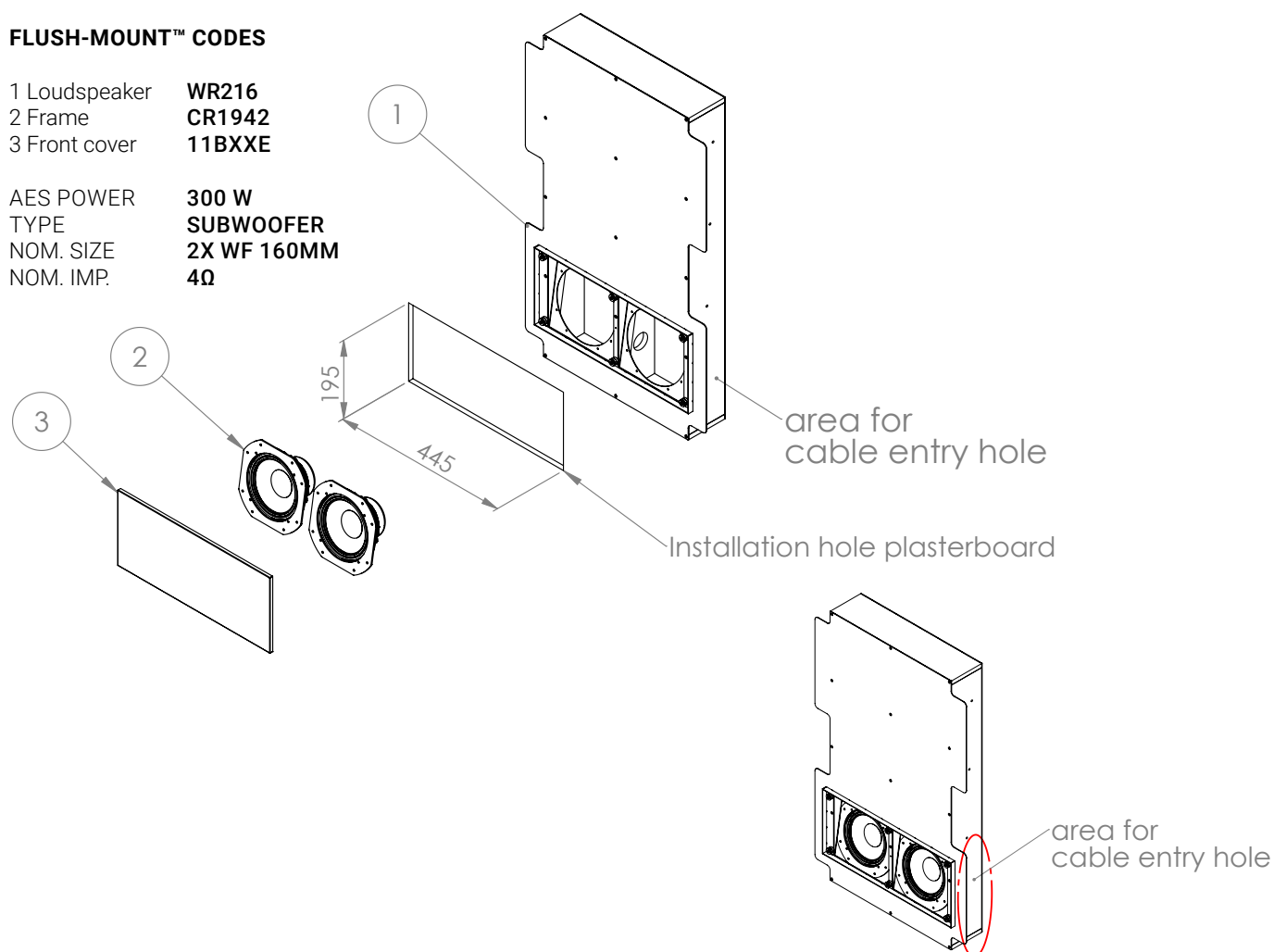

INST. INSTRUCTIONS **WR216 / CR1942 Flush-Mount™ Plasterboard**

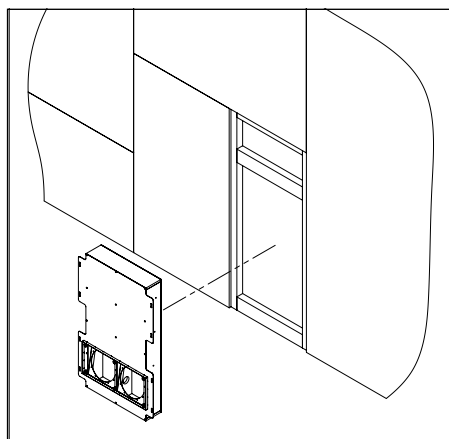

1 Jig set

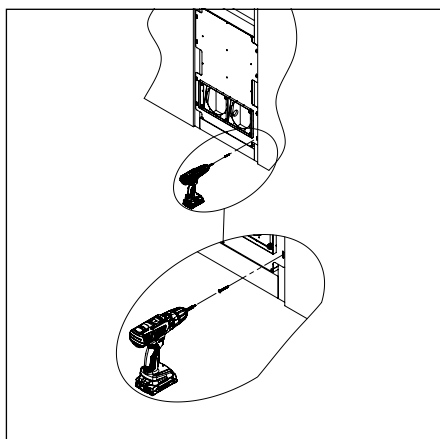

2

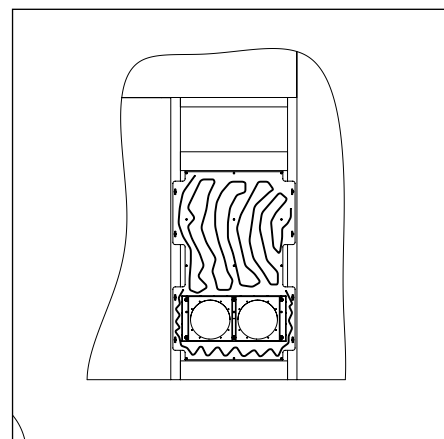

3

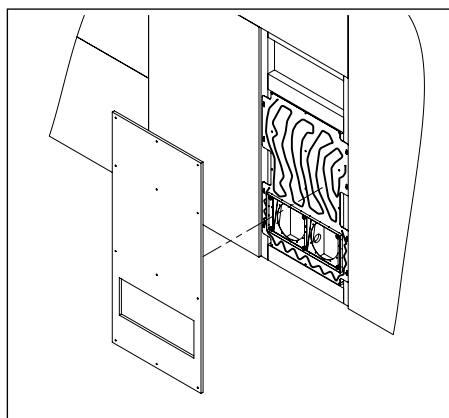

4

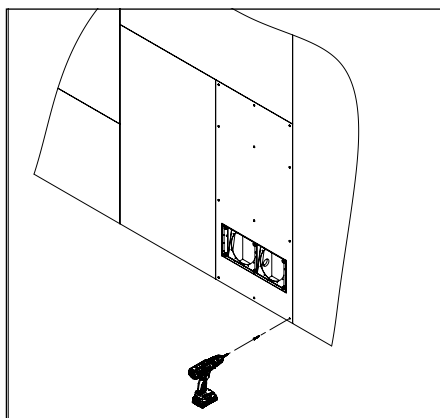

5

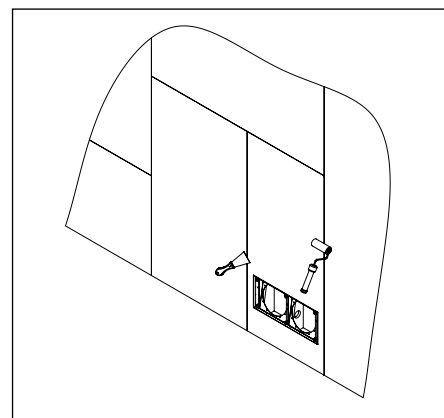

6

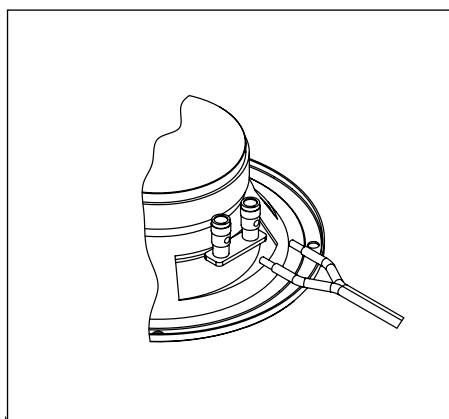

7

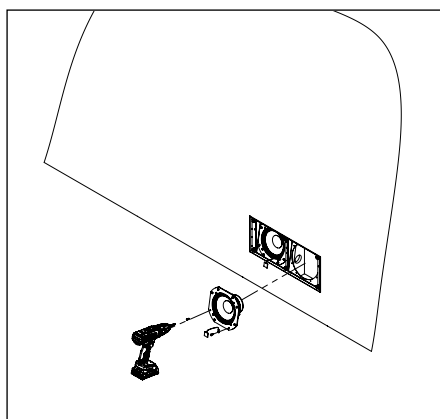

8

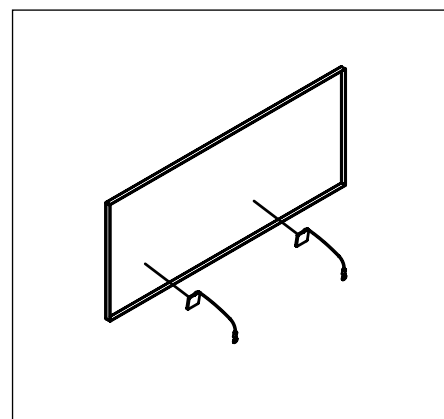

9

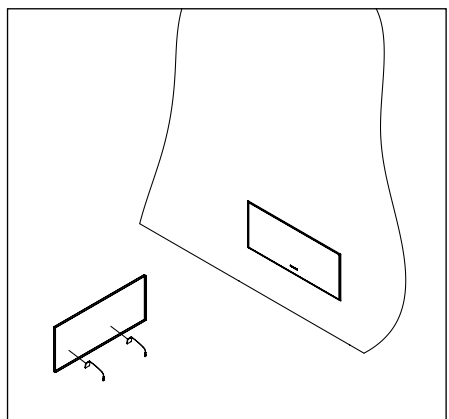

10

